

液  
压  
马  
达  
、  
泵  
及  
元  
器  
件  
大  
型  
生  
产  
基  
地

MANUFACTURING BASE OF HYDRAULIC MOTOR, PUMP AND COMPONENTS.

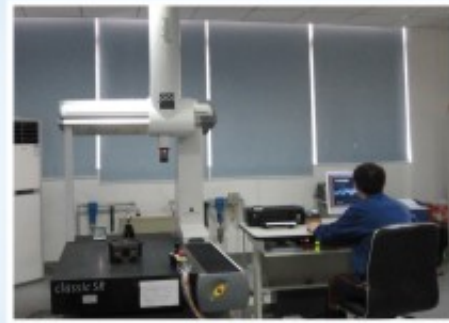

- |   |   |
|---|---|
| 1 | 2 |
| 3 | 4 |
| 5 | 6 |
| 8 | 7 |
| 9 |   |

- 1.HMS马达测试台 HMS Motor Test Board
- 2.立式加工中心 (韩国F500) Korea Vertical Machining Center
- 3.加工中心 Machining Center
- 4.三维测量仪 Three-Dimensional Measuring Instrument
- 5.卧式加工中心 (韩国KH50G) Korea Horizontal Machining Center
- 6.内曲线加工中心 (立式数控曲线磨床MK8580) Incurve Machining Center(Vertical Numerical Control Curve Grinding Machine)
- 7.五轴加工设备 Five axis processing equipment
- 8.加工车间 Process Workshop
- 9.装配车间 Assembly Workshop



**主要产品(Main Products) :**

HVL/HVK/HVN叶片马达、HMS马达、HMCR马达、HDC/HTC铣挖机及其零配件。  
 HVL/HVK/HVN Vane Motor、HMS series Motor、HMCR series Motor、HDC/HTC Drum Cutter and Spare Parts and so on...  
 HMS系列和HMCR系列的零配件能100%替代进口马达零配件，整机马达与进口马达性能接近。  
 The spare parts of our HMS and HMCR series motors can completely replace the imported motor parts.  
 Meanwhile, our motor's performance is close to the imported motors'.  
 HMS02/HMS05/HMS08/HMS11/HMS18/HMCR03 已经通过国家机械测试中心的测试。  
 HMS02/HMS05/HMS08/HMS11/HMS18/HMCR03 series Motors have passed the quality tested by Chinese machinery testing Centre.

## HMCR03/HMCRE03系列液压马达

HMCR03/HMCRE03 series hydraulic motor

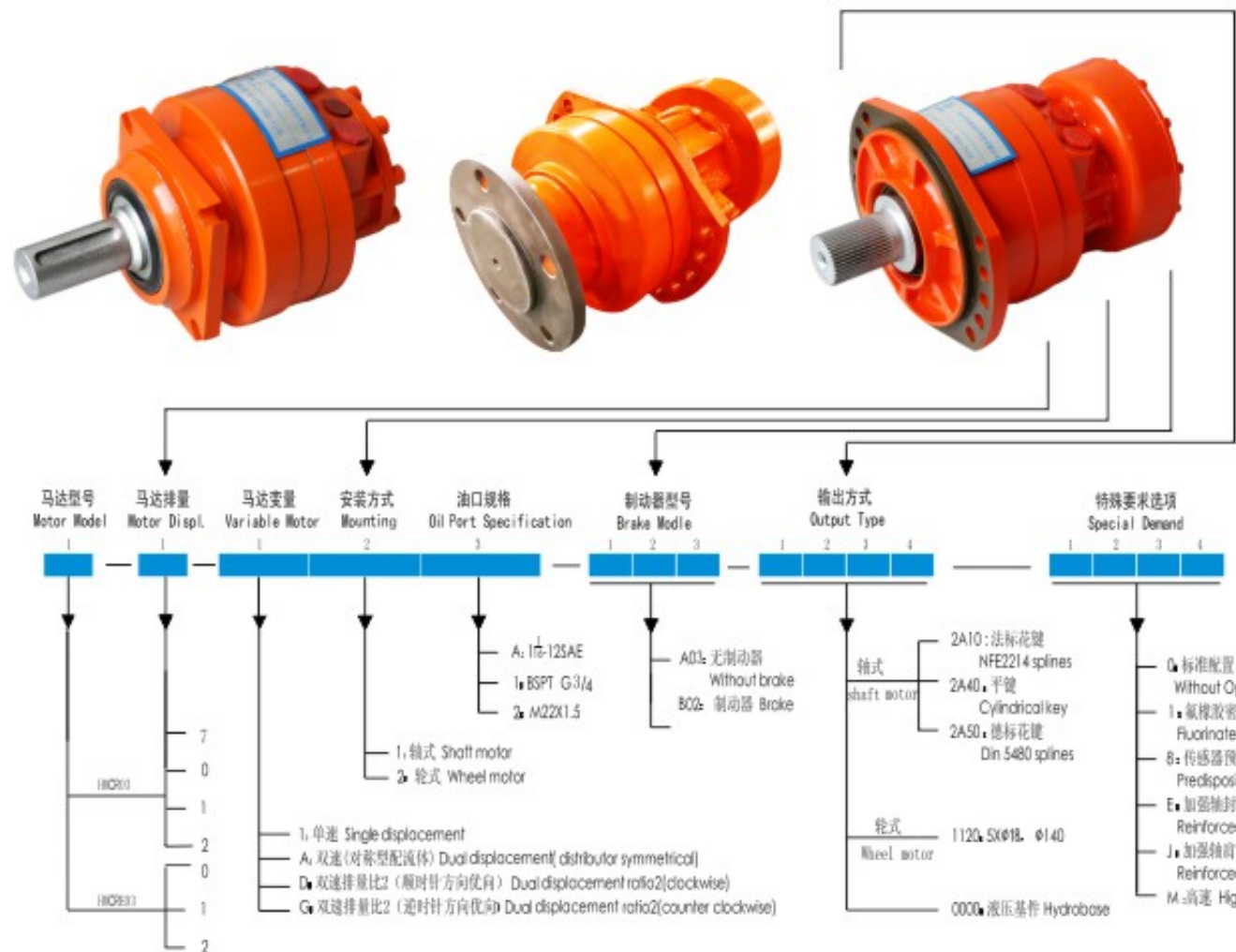

## HMCR03/HMCRE03连接尺寸图

HMCR03/HMCRE03 Connection Dimension

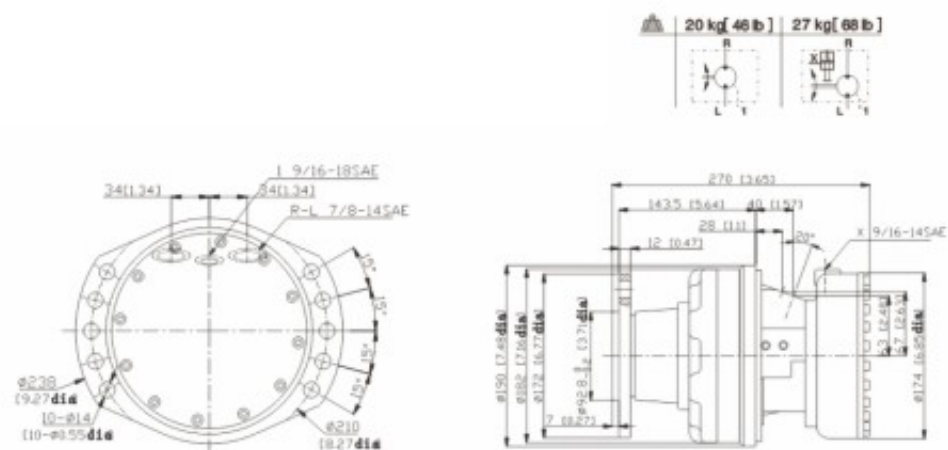

## HMCR03/HMCRE03系列液压马达应用

HMCR03/HMCRE03 series hydraulic motor application

**矿山机械 (Mining Machinery):** 采煤机 (Coal Winning Machine), 掘进机 (Road Header), 刮板机 (Scraper), 重载搬运车 (Heavy Duty Handing Car), 煤矿钻机 (Coal Mine Drill)

**工程机械 (Construction Machinery):** 滑移装载机 (Skid Steer Loader), 潜孔钻机 (Down-The-Hole Drill), 旋挖钻机 (Rotary Drill), 小型挖装机 (Mini And Midi Excavator), 搅拌车 (Mixer Truck), 切削机 (Cutting Machine)

**船舶机械 (甲板机械) (Marine Machinery):** 港口龙门吊 (Gantry Crane)



滑移装载机  
Skid Steer Loader



自走式龙门吊  
Self-Propelled Gantry Crane

## HMCR03/HMCRE03系列排量图

HMCR03/HMCRE03 series displacement diagram

型号 Code	HMCR03				HMCRE03		
	7	0	1	2	0	1	2
排量 Displacement (ml/r)	160	225	255	280	325	365	400
压差10MPa时理论扭矩 Theoretical torque at 10MPa (N.m)	254	357	405	445	516	580	636
额定转速 Rated speed (r/min)	250	160	160	125	160	125	125
额定压力 Rated pressure (Mpa)	25	25	25	25	25	25	25
额定扭矩 Rated torque (N.m)	635	892	1012	1112	1290	1450	1590
最大压力 Max.pressure (Mpa)	31.5	31.5	31.5	31.5	31.5	31.5	31.5
最大扭矩 Max. torque (N.m)	650	910	1030	1130	1310	1470	1620
转速范围 Speed range (r/min)	0-670	0-475	0-420	0-385	0-330	0-295	0-270
最大功率 Max. power (kW)	18	18	18	18	22	22	22

## HMCR05/HMCRE05系列液压马达

HMCR05/HMCRE05 series hydraulic motor

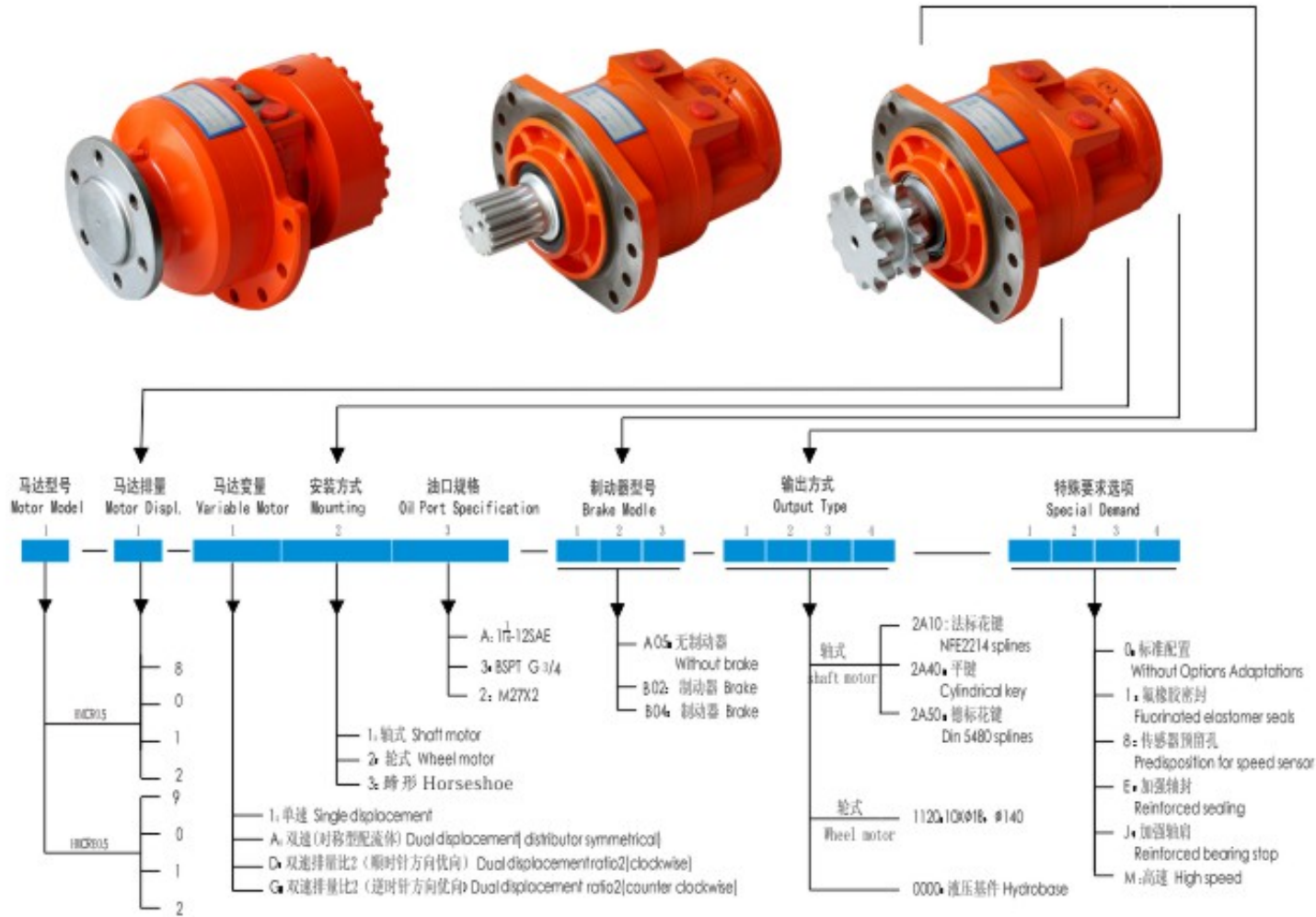

## HMCR05/HMCRE05连接尺寸图

HMCR05/HMCRE05 Connection Dimension

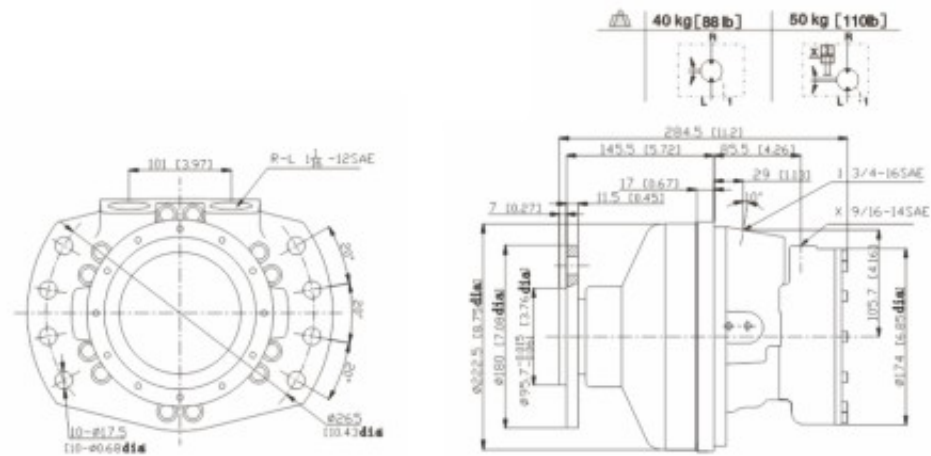

## HMCR05/HMCRE05系列液压马达应用

HMCR05/HMCRE05 series hydraulic motor application

**矿山机械 (Mining Machinery)**: 采煤机 (Coal Winning Machine), 掘进机 (Road Header), 重载搬运车 (Heavy Duty Handling Car), 煤矿钻机 (Coal Mine Drill)  
**工程机械 (Construction Machinery)**: 滑移装载机 (Skid Steer Loader), 破碎机 (Break Machine)



滑移装载机  
Skid Steer Loader



军用越野叉车  
Military off-road forklift

## HMCR05/HMCRE05系列排量图

HMCR05/HMCRE05 series displacement diagram

型号 Code	HMCR05				HMCRE05			
	8	0	1	2	9	0	1	2
排量分组 Displacement Group	8	0	1	2	9	0	1	2
排量 Displacement (ml/r)	380	470	520	565	620	680	750	820
压差10MPa时理论扭矩 Theoretical torque at 10MPa(N.m)	604	747	826	890	985	1080	1192	1302
额定转速 Rated speed (r/min)	160	125	125	125	125	100	100	100
额定压力 Rated pressure (Mpa)	25	25	25	25	25	25	25	25
额定扭矩 Rated torque (N.m)	1510	1867.5	2065	2225	2462.5	2770	2980	3225
最大压力 Max.pressure (Mpa)	31.5	31.5	31.5	31.5	31.5	31.5	31.5	31.5
最大扭矩 Max. torque (N.m)	1540	1900	2100	2290	2510	2750	3040	3320
转速范围 Speed range (r/min)	0-475	0-385	0-350	0-320	0-290	0-265	0-240	0-220
最大功率 Max. power (kW)	29	29	29	29	35	35	35	35

## HMCR10/HMCRE10系列液压马达

HMCR10/HMCRE10 series hydraulic motor

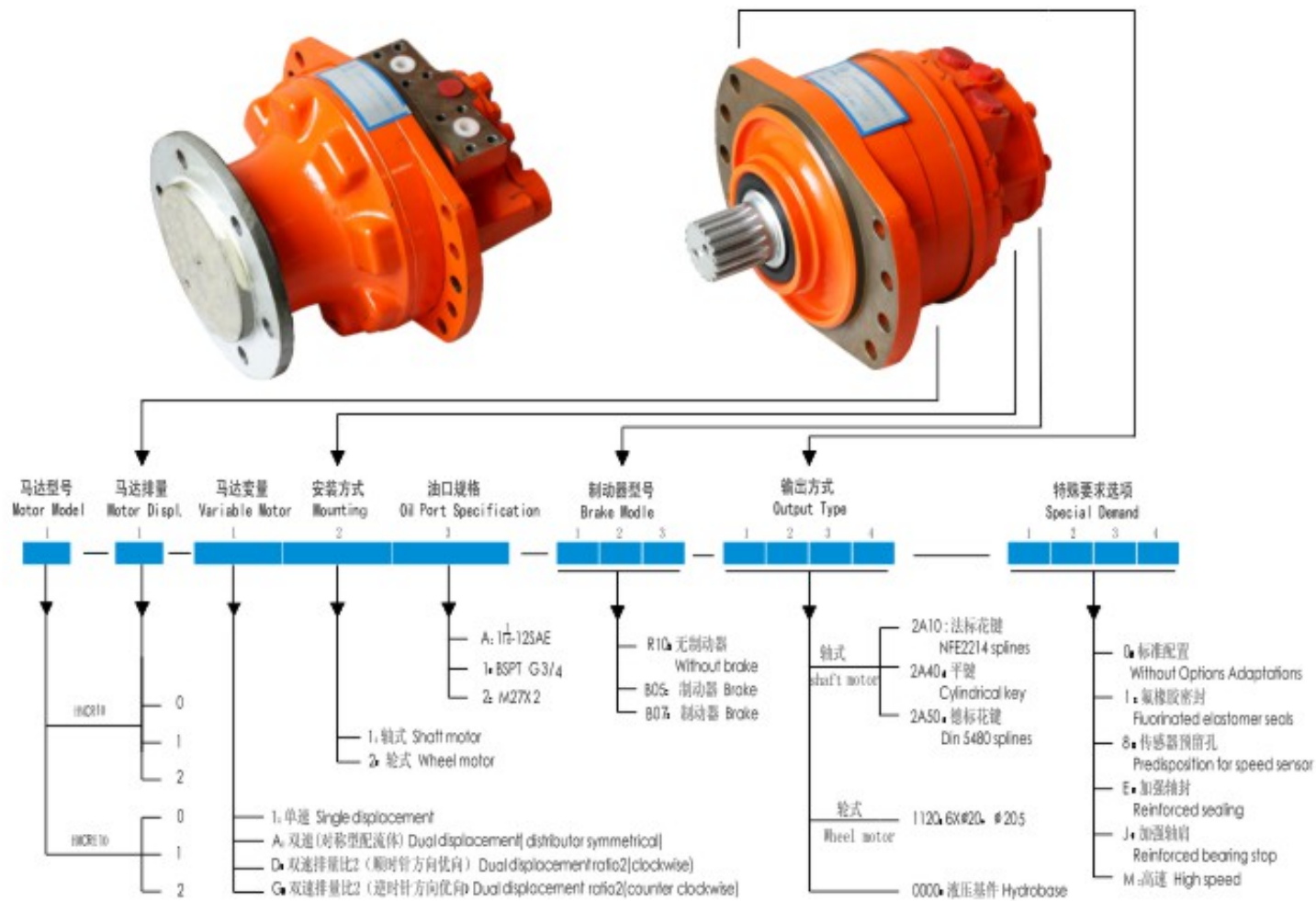

## HMCR10/HMCRE10连接尺寸图

HMCR10/HMCRE10 Connection Dimension

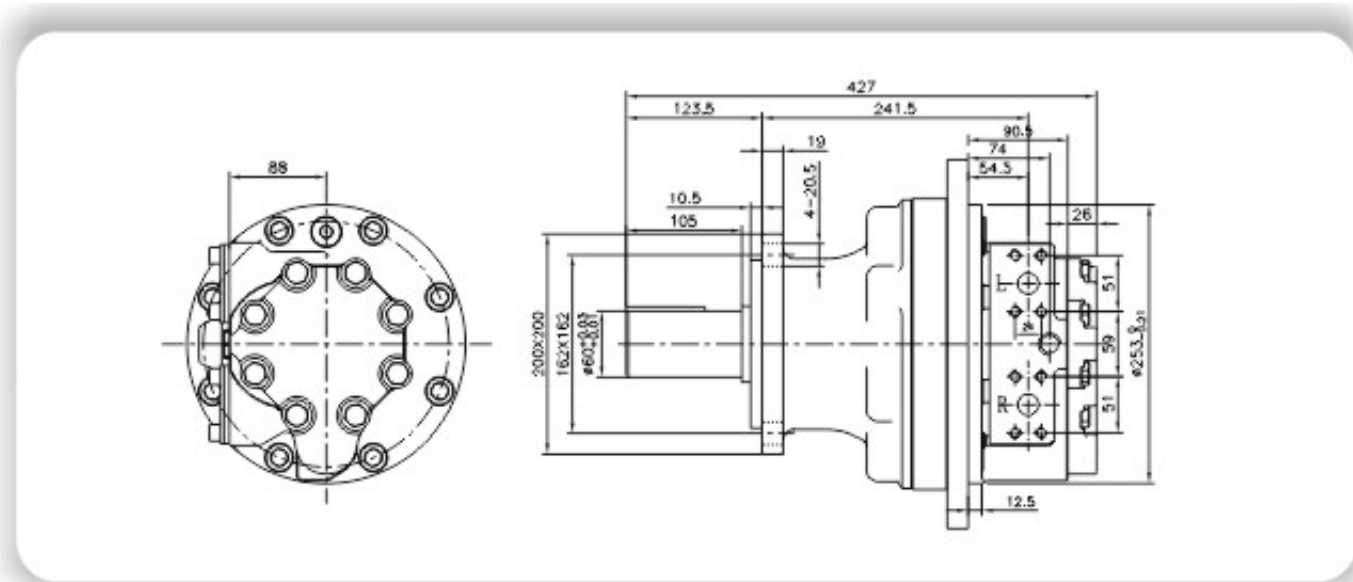

## HMCR10/HMCRE10系列液压马达应用

HMCR10/HMCRE10 series hydraulic motor application

**矿山机械 (Mining Machinery):** 采煤机 (Coal Winning Machine), 掘进机 (Road Header), 重载搬运车 (Heavy Duty Handling Car), 煤矿钻机 (Coal Mine Drill)  
**工程机械 (Construction Machinery):** 滑移装载机 (Skid Steer Loader), 破碎机 (Break Machine),



定量配料机  
Dosing Machine



小型挖掘机  
Mini Excavator

## HMCR10/HMCRE10系列排量图

HMCR10/HMCRE10 series displacement diagram

型号 Code	HMCR10			HMCRE10		
排量分组 Displacement Group	0	1	2	0	1	2
排量 Displacement (ml/r)	780	860	940	1120	1250	1340
压差10MPa时理论扭矩 Theoretical torque at 10MPa (N.m)	1240	1367	1494	1780	1987	2130
额定转速 Rated speed (r/min)	125	100	100	100	80	80
额定压力 Rated pressure (Mpa)	25	25	25	25	25	25
额定扭矩 Rated torque (N.m)	3100	3417.5	3735	4450	4967.5	5325
最大压力 Max. pressure (Mpa)	31.5	31.5	31.5	31.5	31.5	31.5
最大扭矩 Max. torque (N.m)	3160	3480	3810	4540	5060	5430
转速范围 Speed range (r/min)	0-215	0-195	0-180	0-150	0-135	0-125
最大功率 Max. power (kW)	44	44	44	50	50	50



## HMS05/HMSE05系列液压马达

HMS05/HMSE05 series hydraulic motor

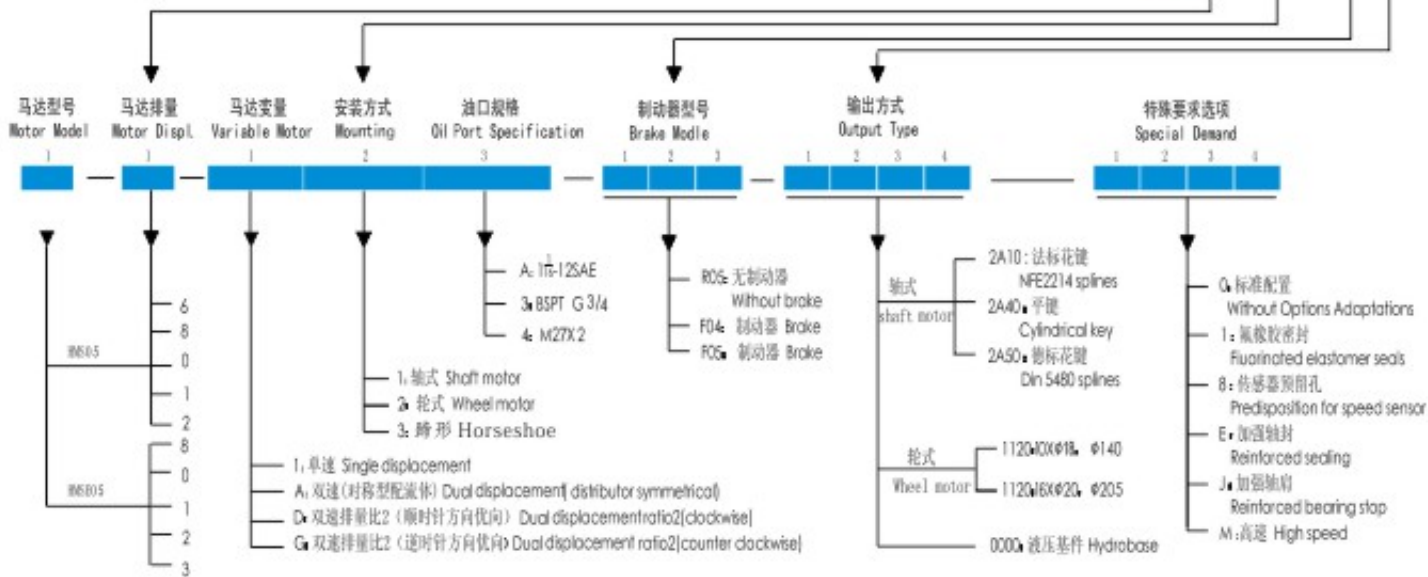

## HMS05/HMSE05连接尺寸图

HMS05/HMSE05 Connection Dimension

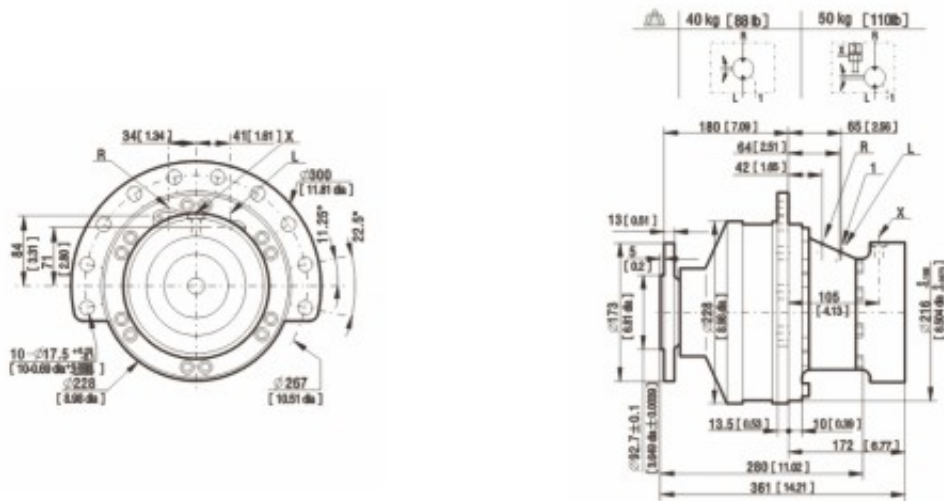

## HMS05/HMSE05系列液压马达应用

HMS05/HMSE05 series hydraulic motor application

**工程机械 (Construction Machinery):** 扒渣机90以上 (Cinder), 滑移装载机 (Skid Steer Loader), 防爆叉车 (Explosion-Proof Forklift), 越野叉车 (Forklift), 运梁机/提梁车 (Beam Carrier/Hoisting Machine),  
**农业机械 (Agricultural Machinery):** 小型农用车 (Mini Farming Vehicle), 玉米收割机 (联合收割机) (Combine Harvester And Cotton Picker),  
**矿山机械 (Mining Machinery):** 630以上刮板机 (Scraper), 掘进机 (Road Header), 重载搬运车 (Heavy Duty Handling Car), 煤矿钻机 (Coal Mine Drill)  
**特种车辆 (Special Vehicle):** 消防车 (Fire Engine)



潜孔钻机  
Down-The-Hole Drill



掘进机  
Road Header

## HMS05/HMSE05系列排量图

HMS05/HMSE05 series displacement diagram

型号 Code	HMS05					HMSE05				
排量分组 Displacement Group	6	8	0	1	2	8	0	1	2	3
排量 Displacement (ml/r)	260	376	468	514	560	503	625	688	750	820
压差10MPa时理论扭矩 Theoretical torque at 10MPa (N.m)	413	598	744	817	890	800	994	1094	1193	1304
额定转速 Rated speed (r/min)	160	160	125	125	125	100	100	100	80	80
额定压力 Rated pressure (Mpa)	25	25	25	25	25	25	25	25	25	25
额定扭矩 Rated torque (N.m)	1033	1495	1860	2043	2225	2000	2485	2735	2983	3260
最大压力 Max. pressure (Mpa)	31.5	31.5	31.5	31.5	31.5	31.5	31.5	31.5	31.5	31.5
最大扭矩 Max. torque (N.m)	1050	1500	1850	2050	2250	2030	2500	2750	3000	3300
转速范围 Speed range (r/min)	0-265	0-250	0-240	0-220	0-200	0-200	0-190	0-175	0-160	0-140
最大功率 Max. power (kW)	标准排量29kW 变量优先旋向19kW 变量非优先旋向15kW. Standard displacement is 29kW, variable displacement priority rotation 19kW, no priority is 15kW.									





## HMS18/HMSE18系列液压马达

HMS18/HMSE18 series hydraulic motor

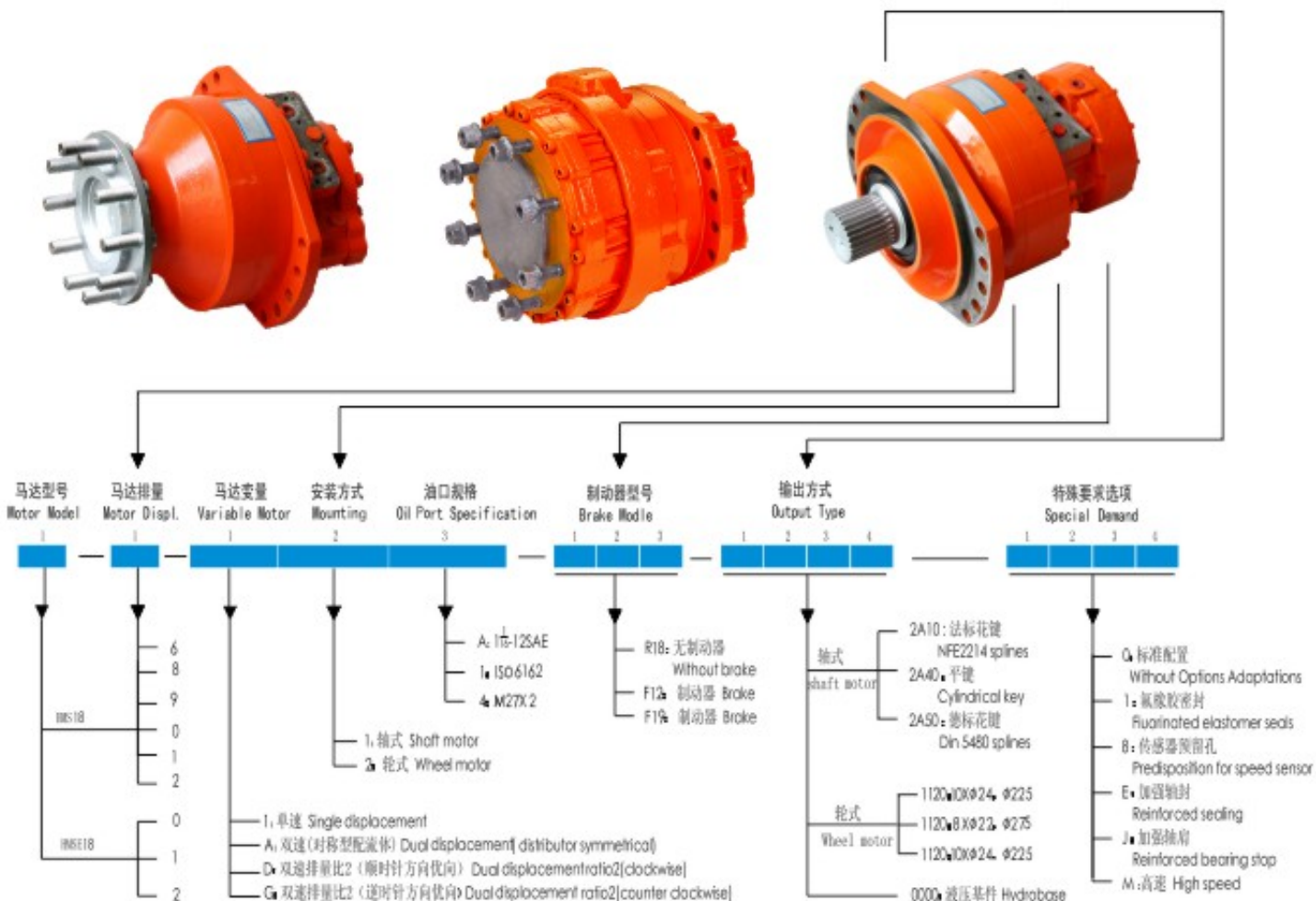

## HMS18/HMSE18连接尺寸图

HMS18/HMSE18 Connection Dimension

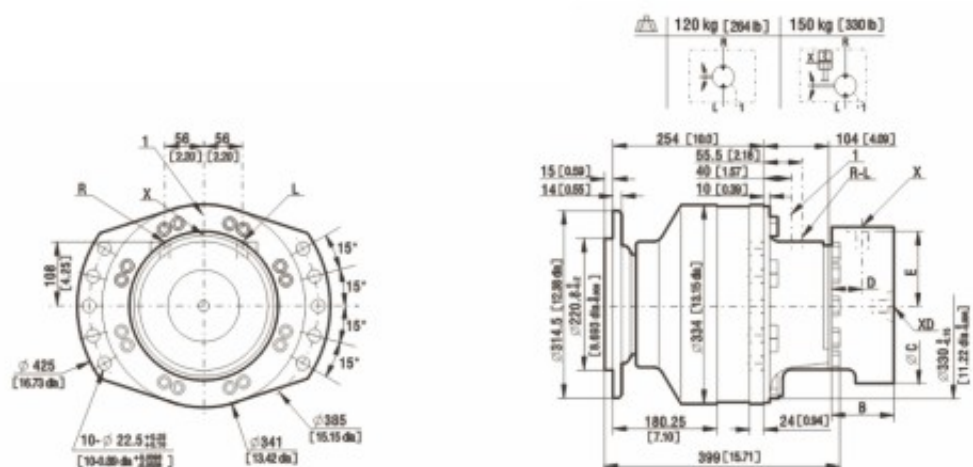

## HMS18/HMSE18系列液压马达应用

HMS18/HMSE18 series hydraulic motor application

**工程机械 (Construction Machinery):** 扒渣机220以上机型 (挖掘装载机) (Backhoe Loader),

防爆叉车 (Explosion-Proof Forklift), 越野叉车 (Forklift)

**矿山机械 (Mining Machinery):** 小型掘进机 (Mini Road Header), 重载搬运车 (Heavy Duty Handling Car),

煤矿钻机 (Coal Mine Drill)

**船舶机械 (甲板机械) (Marine Machinery):** 锚绞机 (Windlass), 克令吊 (Crane)



矿山机械  
Mining Machinery

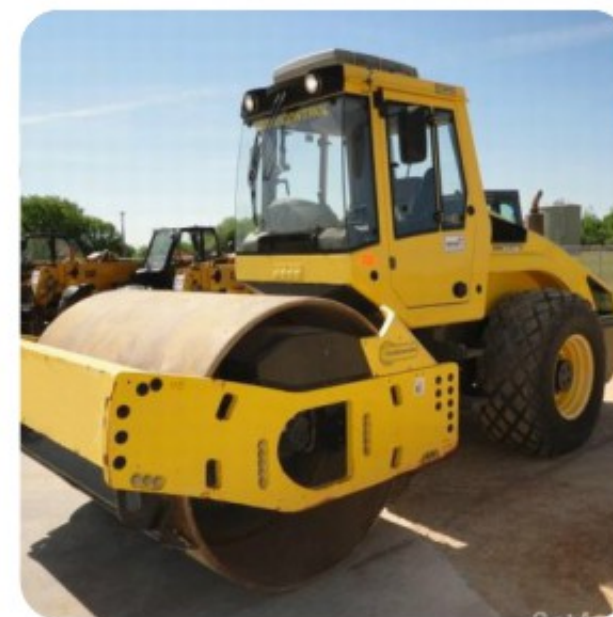

压路机  
Road Roller

## HMS18/HMSE18系列排量图

HMS18/HMSE18 series displacement diagram

型号 Code	HMS18						HMSE18		
	6	8	9	0	1	2	0	1	2
排量分组 Displacement Group									
排量 Displacement (ml/r)	1091	1395	1571	1747	1911	2099	2340	2560	2812
压差10MPa时理论扭矩 Theoretical torque at 10MPa (N.m)	1735	2218	2498	2778	3038	3337	3721	4070	4471
额定转速 Rated speed (r/min)	100	100	100	80	80	80	63	63	50
额定压力 Rated pressure (Mpa)	25	25	25	25	25	25	25	25	25
额定扭矩 Rated torque (N.m)	4338	5545	6245	6945	7595	8343	9303	10175	11178
最大压力 Max. pressure (Mpa)	31.5	31.5	31.5	31.5	31.5	31.5	31.5	31.5	31.5
最大扭矩 Max. torque (N.m)	4420	5650	6350	7050	7700	8500	9450	10350	11400
转速范围 Speed range (r/min)	0-170	0-155	0-140	0-125	0-115	0-100	0-90	0-85	0-75
最大功率 Max. power (kW)	标准排量70kW 变量优先旋转47kW 变量非优先旋转35kW Standard displacement is 70kW, variable displacement priority rotation 47kW, no priority is 35kW								





## HMS50系列液压马达

HMS50 series hydraulic motor

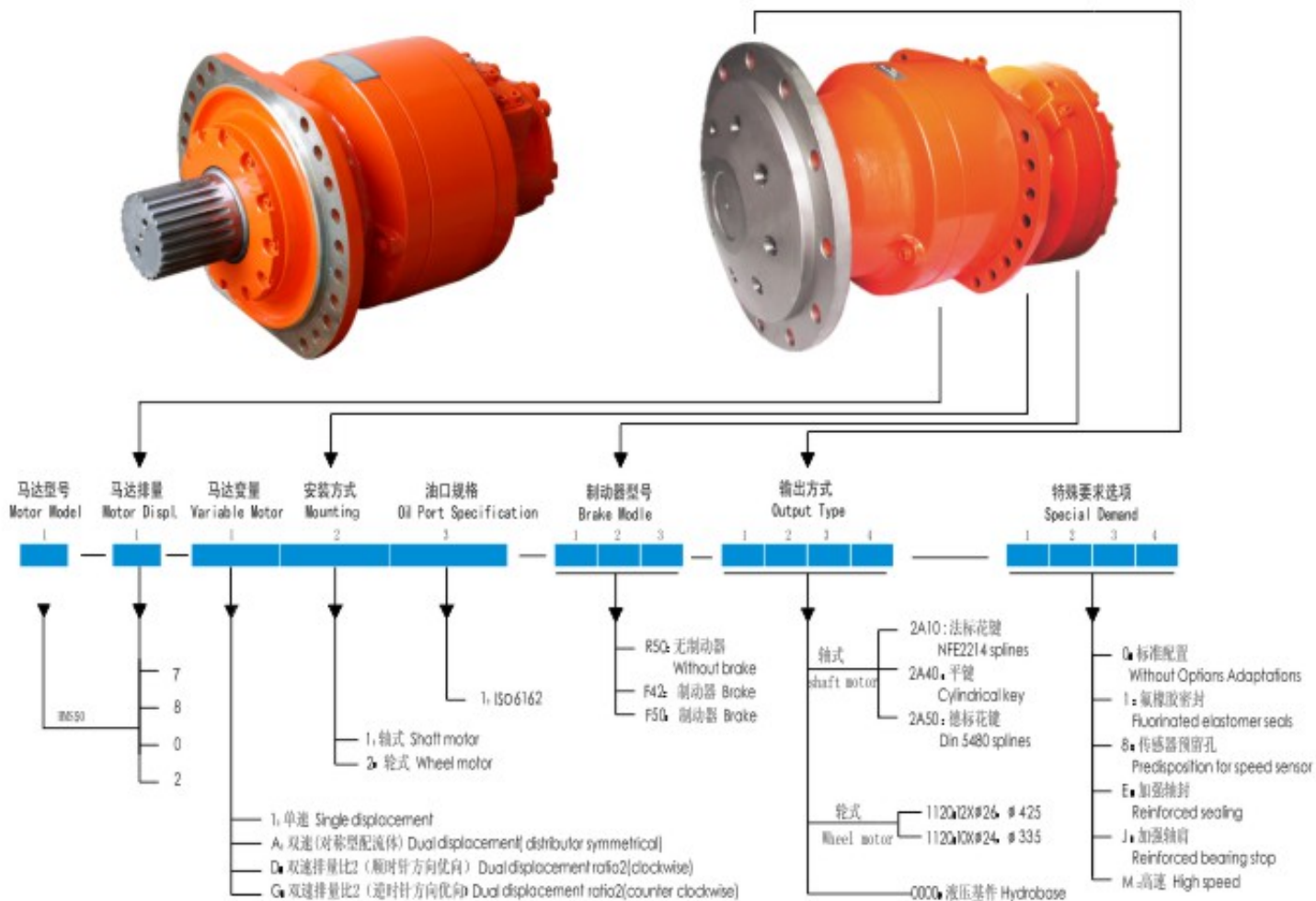

## HMS50连接尺寸图

HMS50 Connection Dimension

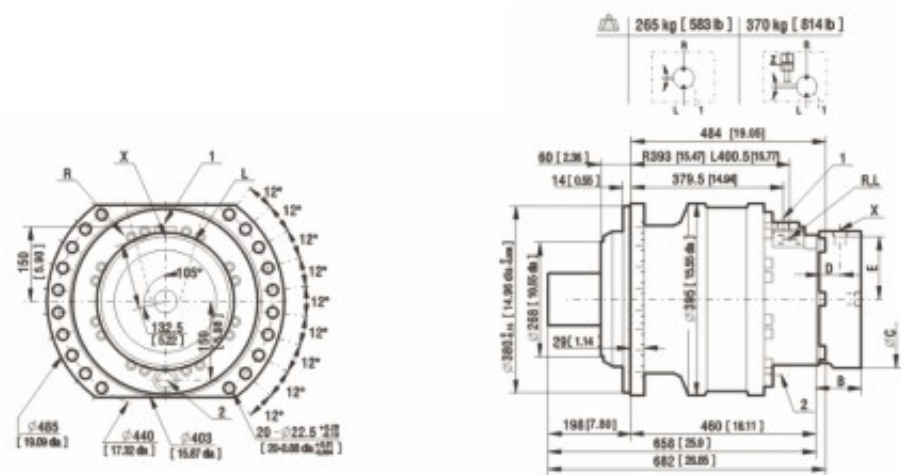

## HMS50系列液压马达应用

HMS50 series hydraulic motor application

**工程机械 (Construction Machinery):** 26T压路机 (MK系列) 26T Road Roller (MK Series), 锻造操作机 (Forging Manipulator), 抓斗机 (Bucket Wheel Machine), 反井钻 (Raise-Bore Machine)

**船舶机械 (甲板机械) (Marine Machinery):** 船用甲板吊机 (Marine Deck Crane), 港口起吊设备 (Gantry Crane Equipment)

**矿山机械 (Mining Machinery):** 重载搬运车 (Heavy Duty Handling Car), 煤矿钻机 (Coal Mine Drill)



锻造操作机  
Forging Manipulator



反井钻  
Raise-Bore Machine

## HMS50系列排量图

HMS50 series displacement diagram

排量分组 Displacement Group	7	8	0	2
排量 Displacement (ml/r)	3500	4008	4997	6011
压差10MPa时理论扭矩 Theoretical torque at 10MPa (N.m)	5565	6373	7945	9557
额定转速 Rated speed (r/min)	80	80	63	50
额定压力 Rated pressure (Mpa)	25	25	25	25
额定扭矩 Rated torque (N.m)	13913	15933	19863	23893
最大压力 Max.pressure (Mpa)	31.5	31.5	31.5	31.5
最大扭矩 Max. torque (N.m)	14150	16250	20250	24350
转速范围 Speed range (r/min)	0-148	0-138	0-111	0-92
最大功率 Max. power (kW)	标准排量140kW 变排量优先转向93kW 变排量非优先转向70kW Standard displacement is 140kW, variable displacement priority rotation 93kW, no priority is 70kW			

## HMS83系列液压马达

HMS83 series hydraulic motor

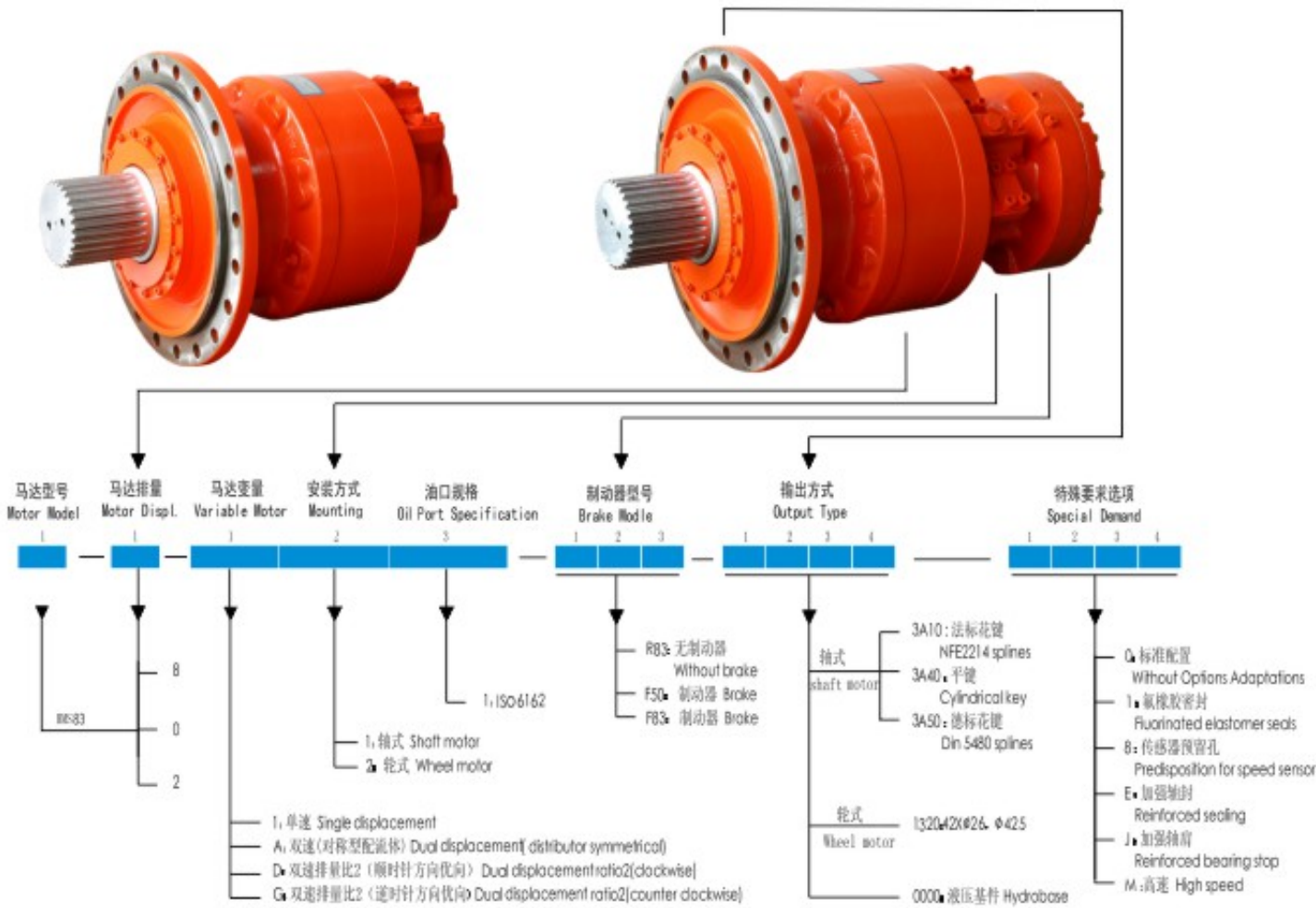

## HMS83连接尺寸图

HMS83 Connection Dimension

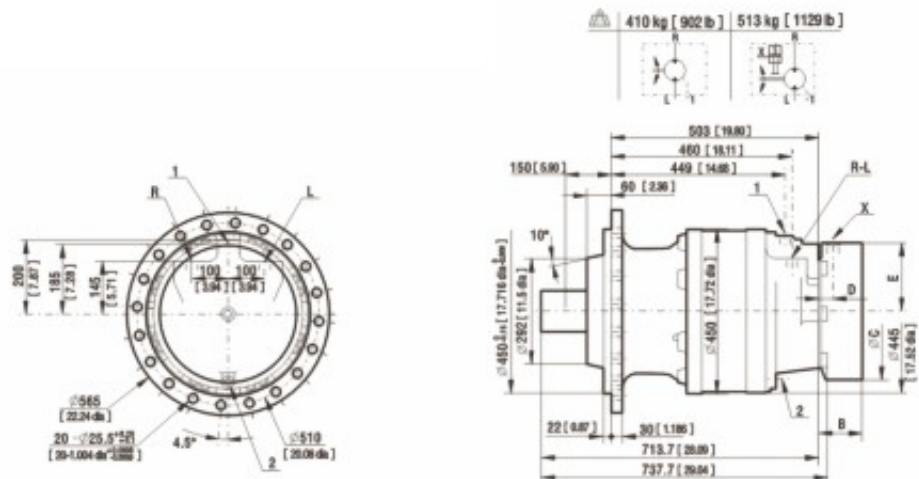

## HMS83系列液压马达应用

HMS83 series hydraulic motor application

**工程机械 (Construction Machinery):** 盾构机 (Shield Machine), 斗轮机 (Bucket Wheel Machine), 石油钻井设备 (Oil Drilling Equipment), 锻造操作机 (Forging Manipulator),  
**矿山机械 (Mining Machinery):** 重载搬运车 (Heavy Duty Handling Car), 煤矿钻机 (Coal Mine Drill)  
**船舶机械 (甲板机械) (Marine Machinery):** 船用甲板吊机 (Marine Deck Crane), 港口起吊设备 (Gantry Crane Equipment)



石油钻井设备  
Oil Drilling Equipment



轧钢机  
Steel Rolling Mill

## HMS83系列排量图

HMS83 series displacement diagram

排量分组 Displacement Group	8	0	2
排量 Displacement (ml/r)	6679	8328	10019
压差10MPa时理论扭矩 Theoretical torque at 10MPa (N.m)	10620	13242	15930
额定转速 Rated speed (r/min)	63	50	40
额定压力 Rated pressure (Mpa)	25	25	25
额定扭矩 Rated torque (N.m)	26550	33105	39825
最大压力 Max. pressure (Mpa)	31.5	31.5	31.5
最大扭矩 Max. torque (N.m)	27050	33750	40600
转速范围 Speed range (r/min)	0-65	0-52	0-43
最大功率 Max. power (kW)			

标准排量220kW 变排量优先取向135kW  
 Standard displacement is 220kW, variable displacement priority rotation 135kW

## HMS125系列液压马达

HMS125 series hydraulic motor

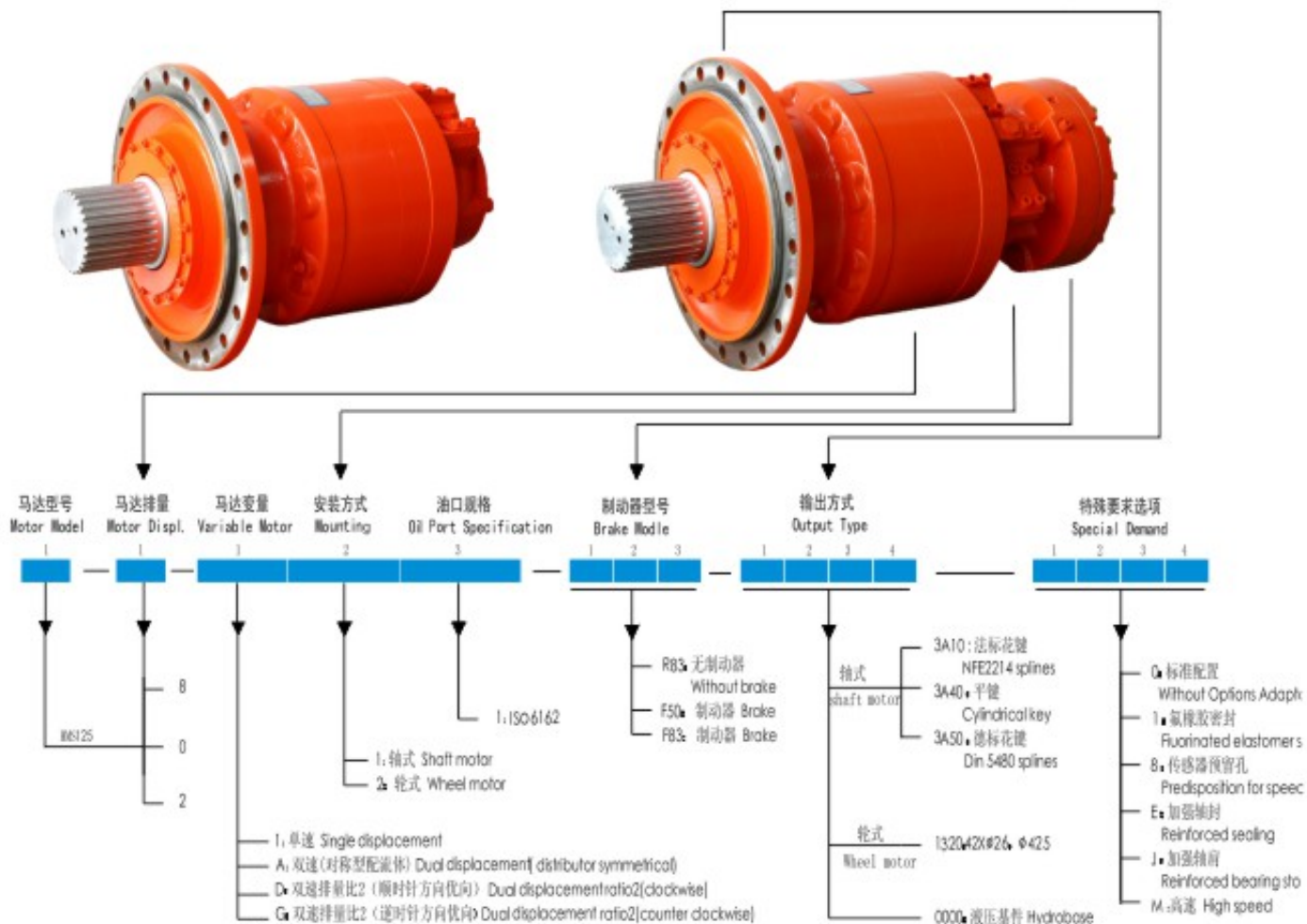

## HMS125连接尺寸图

HMS125 Connection Dimension

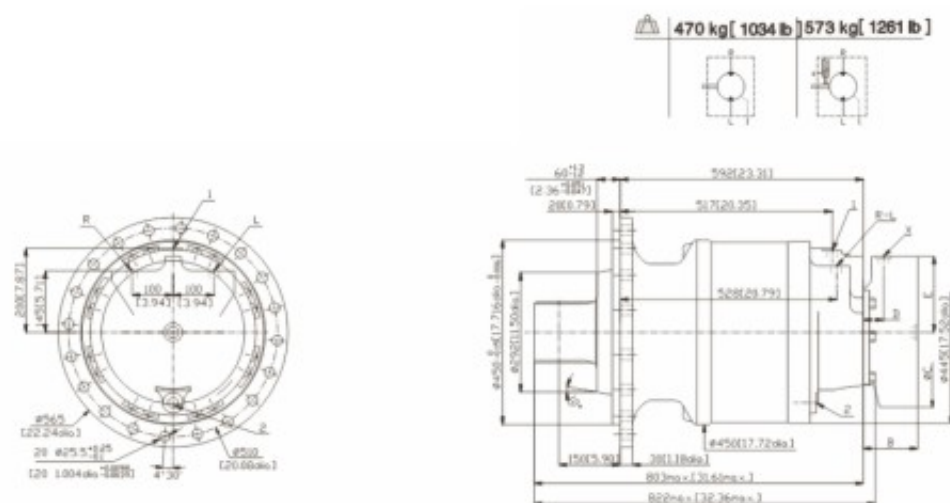

## HMS125系列液压马达应用

HMS125 series hydraulic motor application

工程机械 (Construction Machinery): 盾构机 (Shield Machine), 斗轮机 (Bucket Wheel Machine), 石油钻井设备 (Oil Drilling Equipment)  
 矿山机械 (Mining Machinery): 重载搬运车 (Heavy duty handling car), 煤矿钻机 (Coal mine drill)



盾构机  
Shield Machine



船舶锚绞机  
Marine Windlasses and Mooring Winches

## HMS125系列排量图

HMS125 series displacement diagram

排量分组 Displacement Group	8	0	2
排量 Displacement (ml/r)	10000	12500	15000
压差10MPa时理论扭矩 Theoretical torque at 10MPa (N.m)	15900	19875	23850
额定转速 Rated speed (r/min)	50	40	30
额定压力 Rated pressure (Mpa)	25	25	25
额定扭矩 Rated torque (N.m)	39750	49688	59825
最大压力 Max. pressure (Mpa)	31.5	31.5	31.5
最大扭矩 Max. torque (N.m)	40500	50650	60800
转速范围 Speed range (r/min)	0-50	0-40	0-30
最大功率 Max. power (kW)			

标准排量240kW 变量优先旋向160kW  
 Standard displacement is 240kW, variable displacement priority rotation 160kW

## MK / MKE 系列马达应用

MK / MKE Series Hydraulic Motor Application



## MK/HMK系列马达主要技术性能参数

MK/MKE series Motor main Technical data sheet

排量分组 (Disp Lacement)	MK				MKE			
	8	9	0	1	2	0	1	2
型号 Code	排量 Displacement(ml/r)							
MK04	272		340		408			
MKD04			456	502	545			
MK18	1395	1571	1747	1911	2099	2340	2560	2812
MK23	1395	1571	1747	1911	2099	2340	2560	2812
MK35		3143	3494	3822	4198			

## HVK-7318/HVL-8134/HVN-8223系列叶片马达

HVK series-7318/HVL series-8134/HVN series-8223 vane motor



## HVK/HVL/HVN系列叶片马达主要技术性能参数

HVK/HVL/HVN series Vane Motor main Technical data sheet

Motor type	HVK-A(S)	HVL-A(S)	HVN-S(D)
Motor Code	F2-7318/7317(8136)	F2-8134/8135/8091(8093)	F2-8094(8095/8223)
Rated Rotation r/min	41.7(43)	35/41.3 ( 27.4 )	86.7(89.1/88.4)
supply Oil L/min	305.0(310)	387/456 ( 309 )	309.0(312/310)
Reference oil L/min	309	392/507	\
Efficiency pressure Mpa	12.7(10.4)	11.9/13.4 ( 12.5 )	13.4(10.3/11.3)
Relief valve Adjust pressure Mpa	16.0(13)	15/16.7 ( 16 )	16.7(13/14)
Low speed roll up rotation r/min	41.7(43)	35/41.3 ( 27.4 )	86.7(89.1/88.4)
Middle speed roll up rotation r/min	62.6	52.5/62	\
High speed roll up rotation r/min	125	105/124	178.6(8223)
Roll down limit rotation speed r/min	≤132(≤50)	≤111≤131(≤30)	≤100(≤100/≤175)
Rated load Static skid T(S)	≥20	≥20	≥15
Rated load Hoisting load T(TON)	4.25 ( 3.3 )	7.15/7.15(6.65)	2.10(1.6/1.85)
Displacement L/r	6.741	10.149	3.304
Rated Pressure Mpa	14.7	14.7	14.7
Actual Torque at Rated pressure N*M	14700	22050	7350
Min.Speed r/min	4	4	4
Mechanical efficiency %	96	96	96

## HDC05/HDCE05系列横向铣挖机

HDC05/HDCE05 series Horizontal Drum Cutter



### HDC05/HDCE05连接尺寸图

HDC05/HDCE05 Connection Dimension

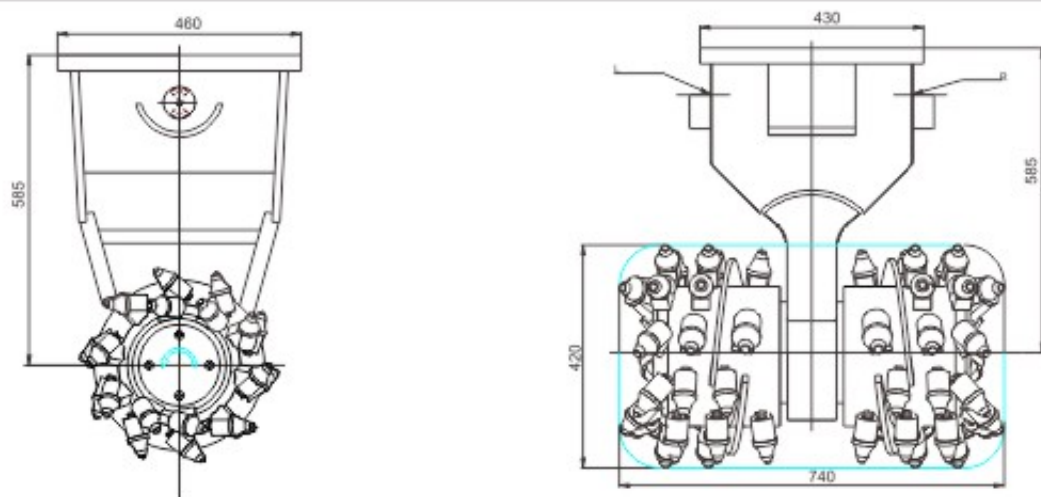

### HDC05/HDCE05系列排量图

HDC05/HDCE05 series displacement diagram

型号 Code	HDC05					HDCE05			
	HDC05-6	HDC05-8	HDC05-0	HDC05-1	HDC05-2	HDCE05-0	HDCE05-1	HDCE05-2	HDCE05-3
排量 Displacement(ml/r)	260	376	468	514	560	625	688	750	820
最大功率 Max.power(KW)	29	29	29	29	29	29	29	29	29
额定压力 Rated pressure(MPa)	25	25	25	25	25	25	25	25	25
最高压力 Max.pressure(MPa)	31.5	31.5	31.5	31.5	31.5	31.5	31.5	31.5	31.5
额定扭矩 Rated torque N.m(25MPa)	1033	1495	1860	2043	2225	2485	2735	2983	3260
最大扭矩 Max. torque N.m(31.5MPa)	1168	1689	2109	2313	2520	2812	3100	3380	3685
额定转速 Rated.speed(rpm)	160	160	125	125	125	100	100	100	100
最大转速 Max.speed(rpm)	265	250	240	220	200	190	175	160	140
齿数 Teeth Number	44								
重量 Weight ( Kg )	381								
适用范围 Suitable range	Suitable Excavator 3-16ton								

## HDC08/HDCE08系列横向铣挖机

HDC08/HDCE08 series Horizontal Drum Cutter



### HDC08/HDCE08连接尺寸图

HDC08/HDCE08 Connection Dimension

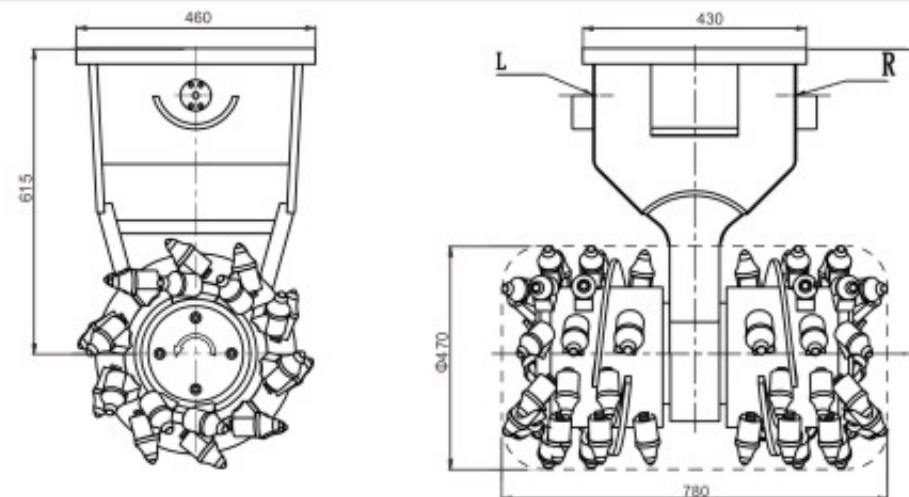

### HDC08/HDCE08系列排量图

HDC08/HDCE08 series displacement diagram

型号 Code	HDC08						HDCE08		
	HDC08-6	HDC08-8	HDC08-9	HDC08-0	HDC08-1	HDC08-2	HDCE08-0	HDCE08-1	HDCE08-2
排量 Displacement(ml/r)	467	627	702	780	857	934	1043	1146	1248
最大功率 Max.power(KW)	41	41	41	41	41	41	41	41	41
额定压力 Rated pressure(MPa)	25	25	25	25	25	25	25	25	25
最高压力 Max.pressure(MPa)	31.5	31.5	31.5	31.5	31.5	31.5	31.5	31.5	31.5
额定扭矩 Rated torque N.m(25MPa)	1858	2493	2790	3100	3408	3713	4145	4555	4960
最大扭矩 Max. torque N.m(31.5MPa)	1890	2500	2800	3150	3450	3750	4200	4600	5050
额定转速 Rated.speed(rpm)	160	160	125	125	100	100	80	80	80
最大转速 Max.speed(rpm)	210	210	185	170	155	140	130	110	105
齿数 Teeth Number	44								
重量 Weight ( Kg )	580								
适用范围 Suitable range	Suitable Excavator 12-18ton								

## HDC18/HDCE18系列横向铣挖机

HDC18/HDCE18 series Horizontal Drum Cutter



### HDC18/HDCE18连接尺寸图

HDC18/HDCE18 Connection Dimension

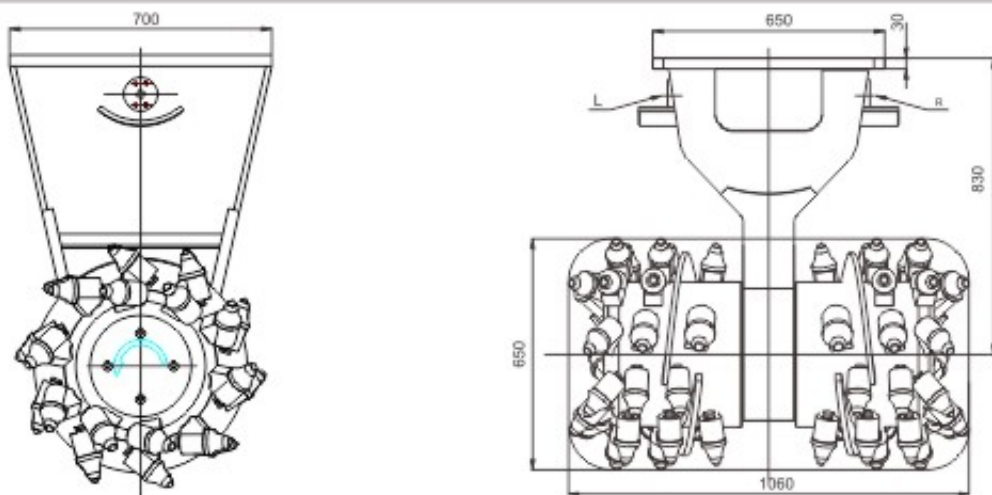

### HDC18/HDCE18系列排量图

HDC18/HDCE18 series displacement diagram

型号 Code	HDC18						HDCE18		
	HDC18-6	HDC18-8	HDC18-9	HDC18-0	HDC18-1	HDC18-2	HDCE18-0	HDCE18-1	HDCE18-2
排量 Displacement(ml/r)	1091	1395	1571	1747	1911	2099	2340	2560	2812
最大功率 Max.power(KW)	70	70	70	70	70	70	70	70	70
额定压力 Rated pressure(MPa)	25	25	25	25	25	25	25	25	25
最高压力 Max.pressure(MPa)	31.5	31.5	31.5	31.5	31.5	31.5	31.5	31.5	31.5
额定扭矩 Rated torque N.m(25MPa)	4338	5545	6245	6945	7595	8343	9303	10175	11178
最大扭矩 Max. torque N.m(31.5MPa)	4910	6280	7076	7869	8594	9457	10546	11539	12675
额定转速 Rated.speed(rpm)	100	100	100	80	80	80	63	63	50
最大转速 Max.speed(rpm)	170	155	140	125	115	100	90	85	75
齿数 Teeth Number	48								
重量 Weight ( Kg )	1370								
适用范围 Suitable range	Suitable Excavator 18-30ton								

## HDC35系列横向铣挖机

HDC35 series Horizontal Drum Cutter



### HDC35连接尺寸图

HDC35 Connection Dimension

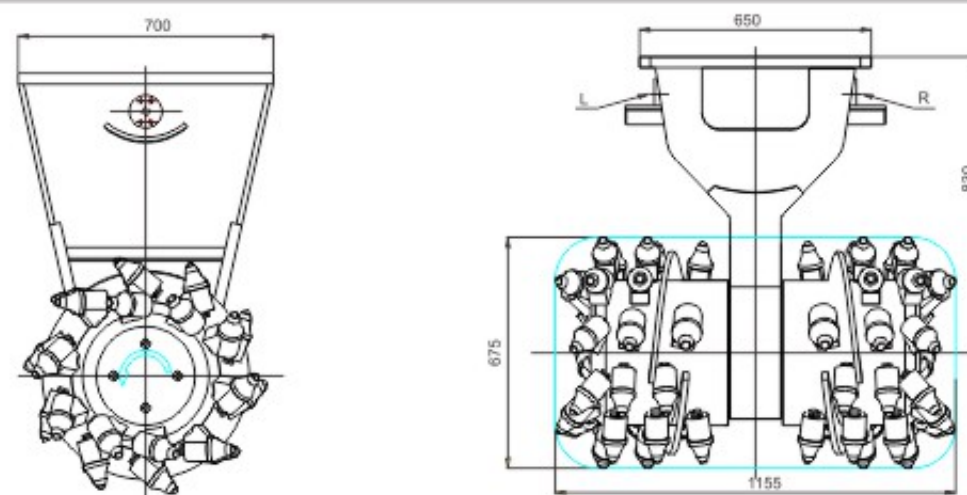

### HDC35系列排量图

HDC35 series displacement diagram

型号 Code	HDC35				
	HDC35-7	HDC35-9	HDC35-0	HDC35-1	HDC35-2
排量 Displacement(ml/r)	2439	3143	3494	3843	4198
最大功率 Max.power(KW)	110	110	110	110	110
额定压力 Rated pressure(MPa)	25	25	25	25	25
最高压力 Max.pressure(MPa)	31.5	31.5	31.5	31.5	31.5
额定扭矩 Rated torque N.m(25MPa)	9695	12493	13888	13740	16688
最大扭矩 Max. torque N.m(31.5MPa)	10900	14100	15740	17300	18900
额定转速 Rated.speed(rpm)	100	80	63	63	63
最大转速 Max.speed(rpm)	140	140	130	120	110
齿数 Teeth Number	48				
重量 Weight ( Kg )	1400				
适用范围 Suitable range	Suitable Excavator 25-40ton				

## HDC50系列横向铣挖机

HDC50 series Horizontal Drum Cutter



### HDC50连接尺寸图

HDC50 Connection Dimension

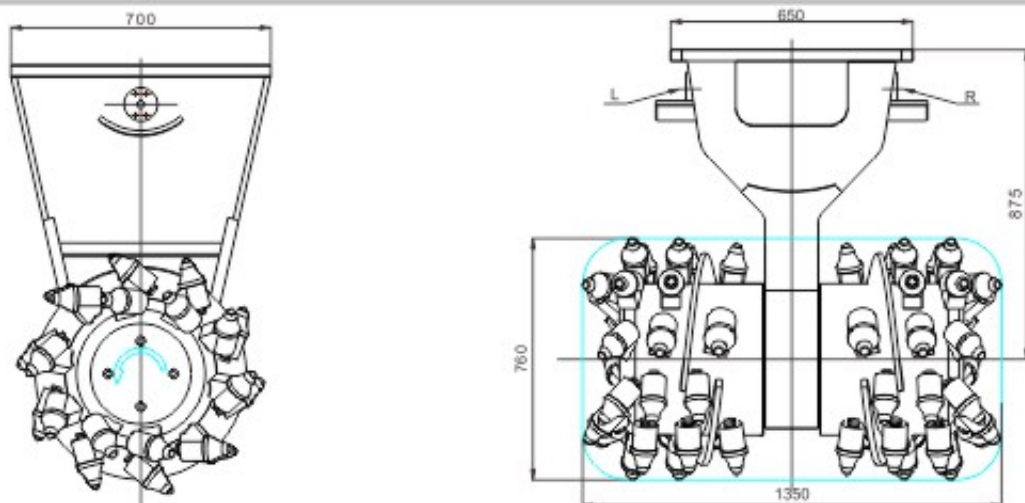

### HDC50系列排量图

HDC50 series displacement diagram

型号 Code	HDC50			
	HDC50-7	HDC50-8	HDC50-0	HDC50-1
排量 Displacement(ml/r)	3500	4008	4997	6011
最大功率 Max.power(KW)	140	140	140	140
额定压力 Rated pressure(MPa)	25	25	25	25
最高压力 Max.pressure(MPa)	31.5	31.5	31.5	31.5
额定扭矩 Rated torque N.m(25MPa)	13913	15933	19863	23893
最大扭矩 Max. torque N.m(31.5MPa)	15760	18000	22500	27000
额定转速 Rated.speed(rpm)	80	80	63	50
最大转速 Max.speed(rpm)	148	138	111	92
齿数 Teeth Number	56			
重量 Weight ( Kg )	1800			
适用范围 Suitable range	Suitable Excavator 35-60ton			

## HTC08/HTCE08系列纵向铣挖机

HTC08/HTCE08 series Vertical Drum Cutter



### HTC08/HTCE08连接尺寸图

HTC08/HTCE08 Connection Dimension

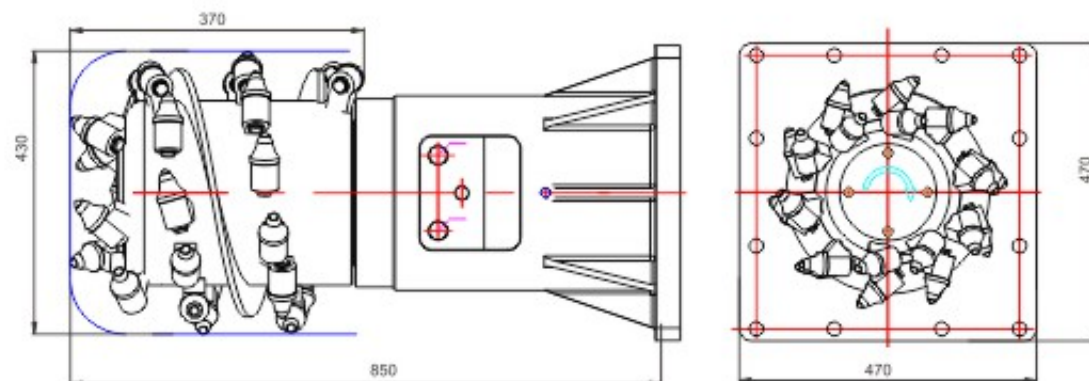

### HTC08/HTCE08系列排量图

HTC08/HTCE08 series displacement diagram

型号 Code	HTC08						HTCE08		
	HTC08-6	HTC08-8	HTC08-9	HTC08-0	HTC08-1	HTC08-2	HTCE08-0	HTCE08-1	HTCE08-2
排量 Displacement(ml/r)	467	627	702	780	857	934	1043	1146	1248
最大功率 Max.power(KW)	41	41	41	41	41	41	41	41	41
额定压力 Rated pressure(MPa)	25	25	25	25	25	25	25	25	25
最高压力 Max.pressure(MPa)	31.5	31.5	31.5	31.5	31.5	31.5	31.5	31.5	31.5
额定扭矩 Rated torque N.m(25MPa)	1858	2493	2790	3100	3408	3713	4145	4555	4960
最大扭矩 Max. torque N.m(31.5MPa)	2105	2820	3160	3510	3860	4210	4700	5160	5620
额定转速 Rated.speed(rpm)	160	160	125	125	100	100	80	80	80
最大转速 Max.speed(rpm)	0-210	0-210	0-185	0-170	0-155	0-140	0-130	0-110	0-105
齿数 Teeth Number	28						28		
重量 Weight ( Kg )	210						210		
适用范围 Suitable range	Suitable Excavator 2.5-6ton						Suitable Excavator 2.5-6ton		

## HTC18/HTCE18系列纵向铣挖机

HTC18/HTCE18 series Vertical Drum Cutter



### HTC18/HTCE18连接尺寸图

HTC18/HTCE18 Connection Dimension

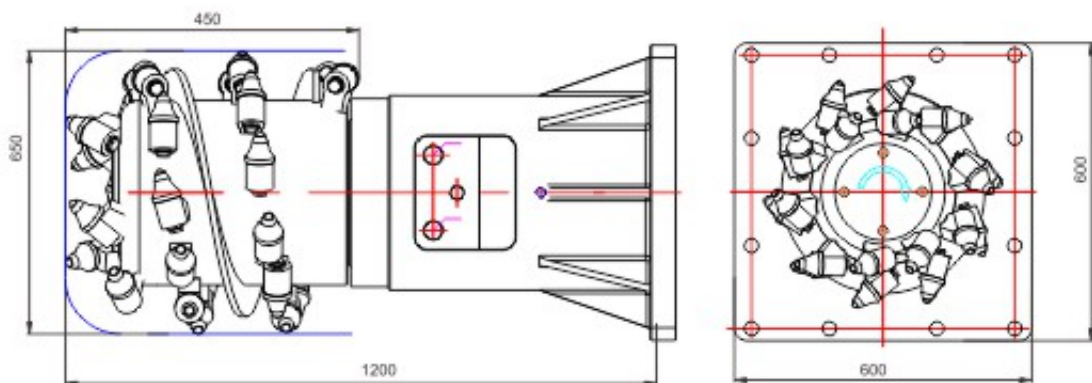

### HTC18/HTCE18系列排量图

HTC18/HTCE18 series displacement diagram

型号 Code	HTC18						HTCE18		
	HTC18-6	HTC18-8	HTC18-9	HTC18-0	HTC18-1	HTC18-2	HTCE18-0	HTCE18-1	HTCE18-2
排量 Displacement(ml/r)	1091	1395	1571	1747	1911	2099	2340	2560	2812
最大功率 Max.power(KW)	70	70	70	70	70	70	70	70	70
额定压力 Rated pressure(MPa)	25	25	25	25	25	25	25	25	25
最高压力 Max.pressure(MPa)	31.5	31.5	31.5	31.5	31.5	31.5	31.5	31.5	31.5
额定扭矩 Rated torque N.m(25MPa)	4338	5545	6245	6945	7595	8343	9303	10175	11178
最大扭矩 Max. torque N.m(31.5MPa)	4910	6280	7076	7869	8594	9457	10546	11539	17733
额定转速 Rated.speed(rpm)	100	100	100	80	80	80	63	63	50
最大转速 Max.speed(rpm)	170	155	140	125	115	100	90	85	75
齿数 Teeth Number	32								
重量 Weight ( Kg )	750								
适用范围 Suitable range	Suitable Excavator 8-15ton								

## HTC35系列纵向铣挖机

HTC35 series Vertical Drum Cutter



### HTC35连接尺寸图

HTC35 Connection Dimension

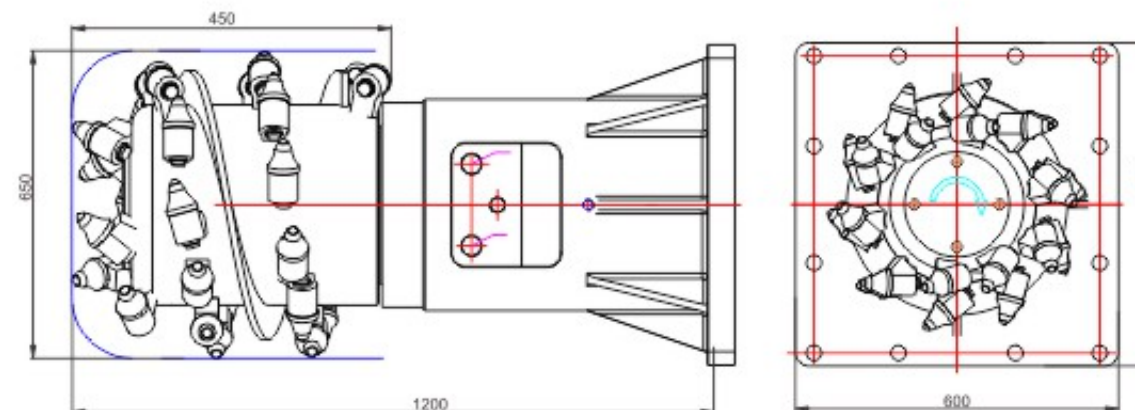

### HTC35系列排量图

HTC35 series displacement diagram

型号 Code	HTC35				
	HTC35-7	HTC35-9	HTC35-0	HTC35-1	HTC35-2
排量 Displacement(ml/r)	2439	3143	3494	3843	4198
最大功率 Max.power(KW)	110	110	110	110	110
额定压力 Rated pressure(MPa)	25	25	25	25	25
最高压力 Max.pressure(MPa)	31.5	31.5	31.5	31.5	31.5
额定扭矩 Rated torque N.m(25MPa)	9695	12493	13888	15240	16688
最大扭矩 Max. torque N.m(31.5MPa)	10900	14100	15740	17300	18900
额定转速 Rated.speed(rpm)	100	80	63	63	63
最大转速 Max.speed(rpm)	140	140	130	120	110
齿数 Teeth Number	32				
重量 Weight ( Kg )	750				
适用范围 Suitable range	Suitable Excavator 18-30ton				

## HF08/HFE08系列螺旋钻机

HF08/HFE08 series Auger Drill



## HF08/HFE08连接尺寸图

HF08/HFE08 Connection Dimension

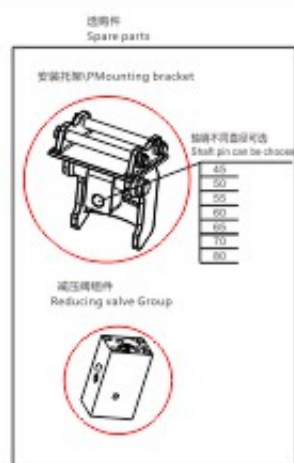
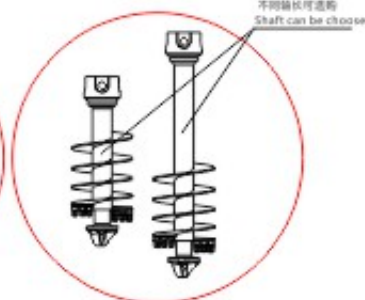

## HF08/HFE08系列排量图

HF08/HFE08 series displacement diagram

型号 Code	HF08		HFE08	
	HF08-0	HF08-2	HFE08-0	HFE08-2
排量 Displacement(ml/r)	780	934	1043	1248
最大功率 Max.power(KW)	41	41	41	41
额定压力 Rated pressure(MPa)	25	25	25	25
最高压力 Max.pressure(MPa)	31.5	31.5	31.5	31.5
额定扭矩 Rated torque N.m(25MPa)	3100	3713	4145	4960
最大扭矩 Max. torque N.m(31.5MPa)	3510	4210	4700	5620
额定转速 Rated.speed(rpm)	125	100	80	80
最大转速 Max.speed(rpm)	0-170	0-140	0-130	0-105
产品高度 Height (mm)	810			
马达油口尺寸 Motor oil port size	1/2"BSP			
输出轴 Output shaft	75 mm SQ			

普通地质钻杆及加长杆  
General geology drill rod and extension rod

钻杆直径 (mm) Drill rod Dia.	钻孔深度 (米) Drill hole depth (M)		
	松地质 Losse geology	中等地质 Medium geology	硬地质 Hard rock geology
100-600	4.5	4.2	3.5
650	3.2	3.7	3.3
700	3.0	2.8	2.5
750	2.6	2.4	2.1
800	2.0	1.8	1.7
850	1.7	1.6	1.4
900	1.5	1.3	1.2
钻杆长度 (米) Drill rod length (M)	1.5		

## HF18/HFE18系列螺旋钻机

HF18/HFE18 series Auger Drill



## HF18/HFE18连接尺寸图

HF18/HFE18 Connection Dimension

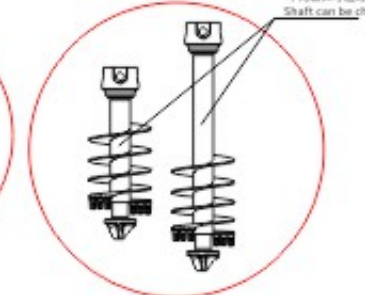

## HF18/HFE18系列排量图

HF18/HFE18 series displacement diagram

型号 Code	HF18		HFE18	
	HF18-0	HF18-2	HFE18-0	HFE18-2
排量 Displacement(ml/r)	1747	2099	2340	2812
最大功率 Max.power(KW)	70	70	70	70
额定压力 Rated pressure(MPa)	25	25	25	25
最高压力 Max.pressure(MPa)	31.5	31.5	31.5	31.5
额定扭矩 Rated torque N.m(25MPa)	6945	8343	9503	11178
最大扭矩 Max. torque N.m(31.5MPa)	7869	9457	10548	12675
额定转速 Rated.speed(rpm)	80	80	63	63
最大转速 Max.speed(rpm)	125	100	90	75
产品高度 Height (mm)	930			
马达油口尺寸 Motor oil port size	3/4"BSP Or 1-1/4" BSP			
输出轴 Output shaft	110 mm SQ			

普通地质钻杆及加长杆  
General geology drill rod and extension rod

钻杆直径 (mm) Drill rod Dia.	钻孔深度 (米) Drill hole depth (M)		
	松地质 Losse geology	中等地质 Medium geology	硬地质 Hard rock geology
100-500	6.5	5.5	5
550	4.5	4.5	3.5
600	4.0	3.7	3.5
650	4.0	3.7	3.5
700	4.0	3.7	3.2
750	3.6	3.5	3.0
800	3.0	2.8	2.4
850	2.7	2.6	2.4
900	2.5	2.2	2.0
钻杆长度 (米) Drill rod length (M)	1.75		



产品详细介绍 (Products are introduced in detail):

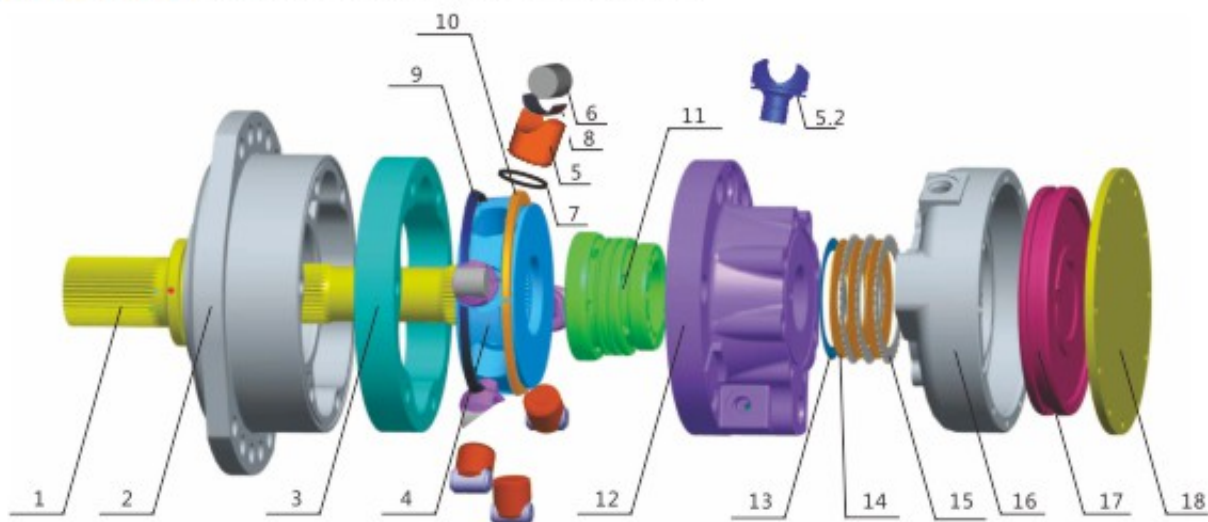

**HMCRO3/HMCRE03** 系列零件名称表  
HMCRO3/HMCRE03 series parts list

序号 (ITEM)	部件名称 (DESCRIPTION)	数量 (QUANTITY)	备注 (REMARK)	序号 (ITEM)	部件名称 (DESCRIPTION)	数量 (QUANTITY)	备注 (REMARK)
1	传动轴 DRIVE SHAFT	1		10	弹性挡圈 CLIP RING	2	
2	前盖 FRONT COVER	1		11	配流轴 DISTRIBUTOR	1	
3	定子 STATOR	1		12	后盖 REAR COVER	1	
4	转子 ROTOR	1		13	调节垫片 ADJUSTING SHIM	2	
5.1	柱塞 PLUNGER PISTON	8	HMCRO3	14	动摩擦片 DYNAMIC FRICTION	13	
5.2	柱塞 PLUNGER PISTON	8	HMCRE03	15	静摩擦片 STATIC FRICTION	15	
6	滚子 ROLLER	8		16	制动缸 BRAKE CYLINDER	1	
7	活塞环 PISTON RING	8		17	制动活塞 BRAKE PLUNGER	1	
8	无油轴承 BUSHING	8		18	制动缸盖 COVER PLATE	1	
9	挡环 BAFFLE RING	2					



产品详细介绍 (Products are introduced in detail):

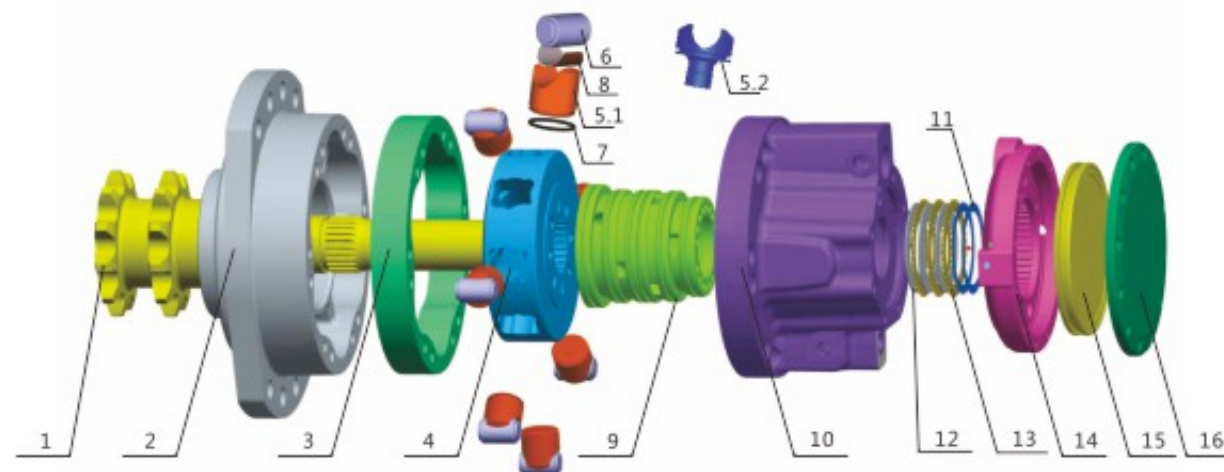

**HMCRO5/HMCRE05** 系列零件名称表  
HMCRO5/HMCRE05 series parts list

序号 (ITEM)	部件名称 (DESCRIPTION)	数量 (QUANTITY)	备注 (REMARK)	序号 (ITEM)	部件名称 (DESCRIPTION)	数量 (QUANTITY)	备注 (REMARK)
1	传动轴 DRIVE SHAFT	1		9	配流轴 DISTRIBUTOR	1	
2	前盖 FRONT COVER	1		10	后盖 REAR COVER	1	
3	定子 STATOR	1		11	调节垫片 ADJUSTING SHIM	2	
4	转子 ROTOR	1		12	动摩擦片 DYNAMIC FRICTION	13	
5.1	柱塞 PLUNGER PISTON	8	HMCRO5	13	静摩擦片 STATIC FRICTION	15	
5.2	柱塞 PLUNGER PISTON	8	HMCRE05	14	制动缸 BRAKE CYLINDER	1	
6	滚子 ROLLER	8		15	制动活塞 BRAKE PLUNGER	1	
7	活塞环 PISTON RING	8		16	制动缸盖 COVER PLATE	1	
8	无油轴承 BUSHING	8					



产品详细介绍 (Products are introduced in detail):

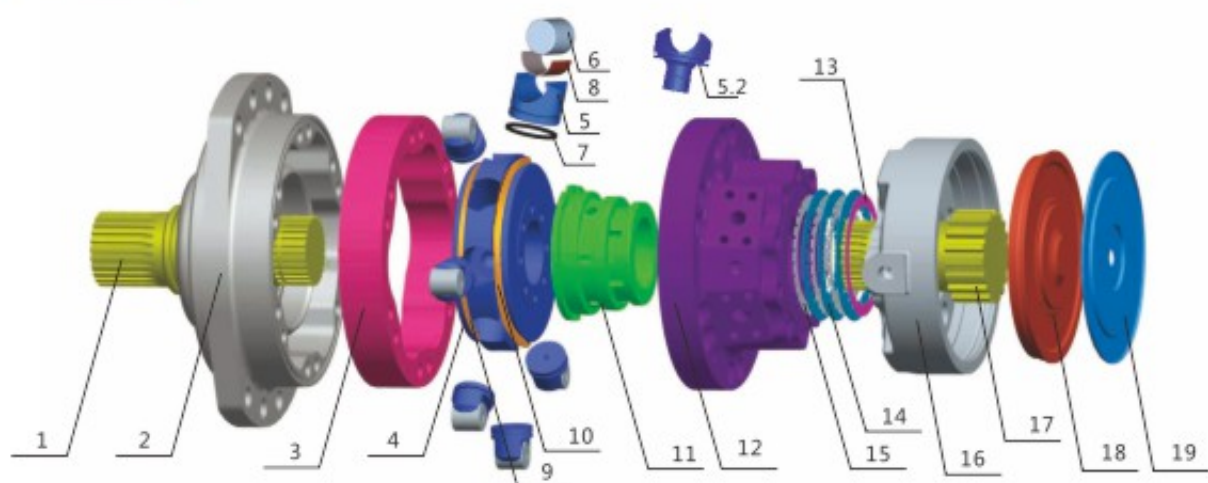

**HMCR10/HMCRE10** 系列零件名称表  
HMCR10/HMCRE10 series parts list

序号(ITEM)	部件名称(DESCRIPTION)	数量(QUANTITY)	备注(REMARK)	序号(ITEM)	部件名称(DESCRIPTION)	数量(QUANTITY)	备注(REMARK)
1	传动轴 DRIVE SHAFT	1		11	配流轴 DISTRIBUTOR	1	
2	前盖 FRONT COVER	1		12	后盖 REAR COVER	1	
3	定子 STATOR	1		13	调节垫片 ADJUSTING SHIM	1	
4	转子 ROTOR	1	HMS10	14	动摩擦片 DYNAMIC FRICTION	14	
5	柱塞 PLUNGER PISTON	10	HMSE10	15	静摩擦片 STATIC FRICTION	15	
6	滚子 ROLLER	10		16	制动缸 BRAKE CYLINDER	1	
7	活塞环 PISTON RING	10		17	制动轴 BRAKE SHAFT	1	
8	无油轴承 BUSHING	10		18	制动活塞 BRAKE PLUNGER	1	
9	挡环 BAFFLE RING	2		19	制动缸盖 COVER PLATE	1	
10	弹性挡圈 CLIP RING	2					



产品详细介绍 (Products are introduced in detail):

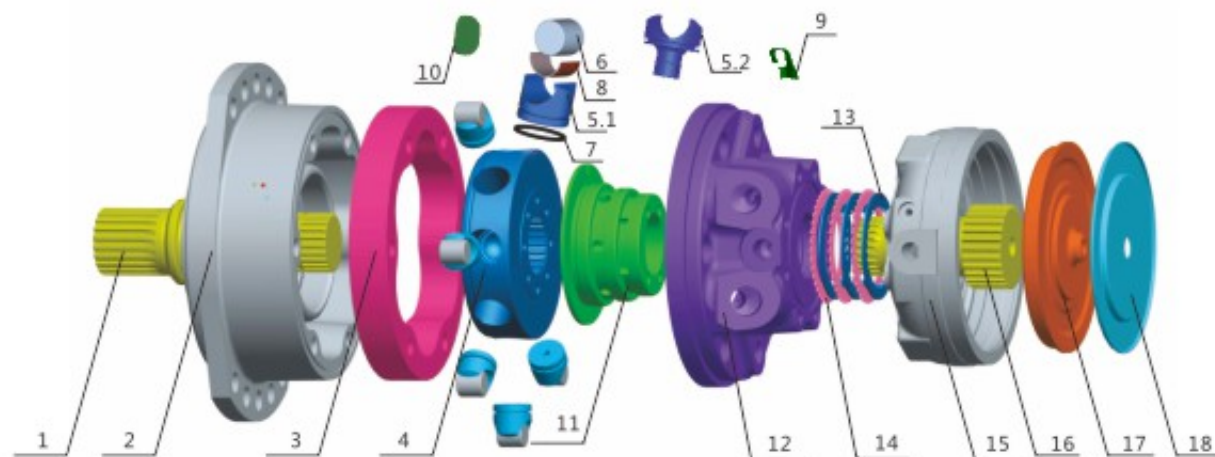

**HMS02/HMSE02** 系列零件名称表  
HMS02/HMSE02 series parts list

序号(ITEM)	部件名称(DESCRIPTION)	数量(QUANTITY)	备注(REMARK)	序号(ITEM)	部件名称(DESCRIPTION)	数量(QUANTITY)	备注(REMARK)
1	传动轴 DRIVE SHAFT	1		10	柱塞挡板 PLASTIC BLOCK	16	
2	前盖 FRONT COVER	1		11	配流轴 DISTRIBUTOR	1	
3	定子 STATOR	1		12	后盖 REAR COVER	1	
4	转子 ROTOR	1		13	动摩擦片 DYNAMIC FRICTION	10	
5.1	柱塞 PLUNGER PISTON	8	HMS02	14	静摩擦片 STATIC FRICTION	10	
5.2	柱塞 PLUNGER PISTON	8	HMSE02	15	制动缸 BRAKE CYLINDER	1	
6	滚子 ROLLER	8		16	制动轴 BRAKE SHAFT	1	
7	活塞环 PISTON RING	8		17	制动活塞 BRAKE PLUNGER	1	
8	无油轴承 BUSHING	8		18	制动缸盖 COVER PLATE	1	
9	弹簧销 SPRING PIN	8					



产品详细介绍 (Products are introduced in detail):

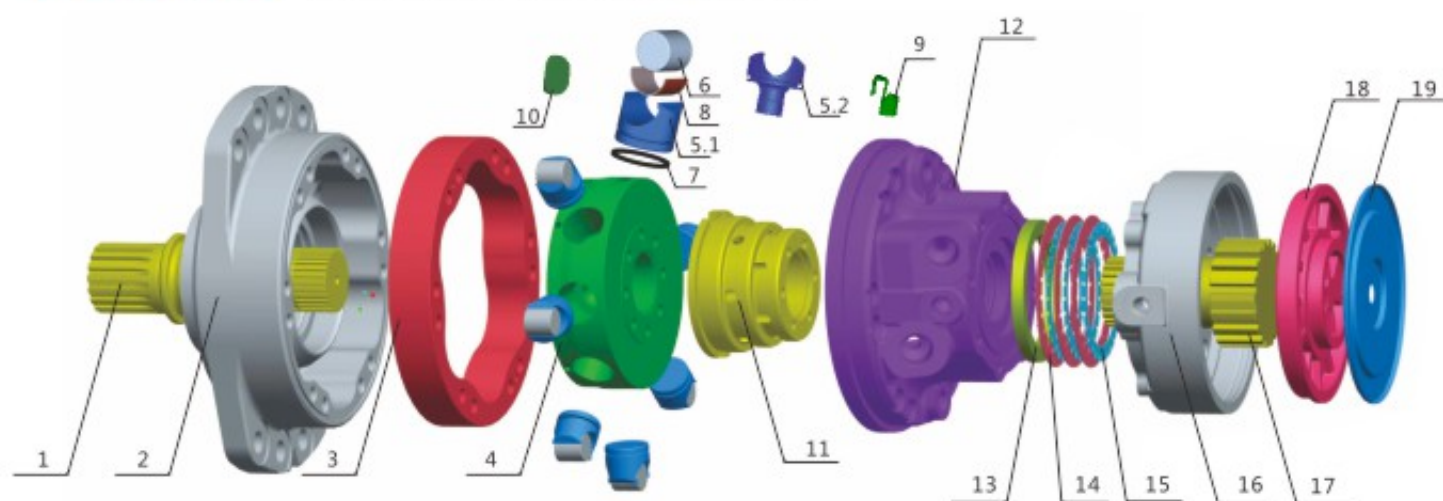

**HMS05/HMSE05**系列零件名称表  
HMS05/HMSE05 series parts list

序号 (ITEM)	部件名称 (DESCRIPTION)	数量 (QUANTITY)	备注 (REMARK)	序号 (ITEM)	部件名称 (DESCRIPTION)	数量 (QUANTITY)	备注 (REMARK)
1	传动轴 DRIVE SHAFT	1		10	柱塞挡板 PLASTIC BLOCK	16	
2	前盖 FRONT COVER	1		11	配流轴 DISTRIBUTOR	1	
3	定子 STATOR	1		12	后盖 REAR COVER	1	
4	转子 ROTOR	1		13	调节垫片 ADJUSTING SHIM	1	
5.1	柱塞 PLUNGER PISTON	8	HMS05	14	动摩擦片 DYNAMIC FRICTION	14	
5.2	柱塞 PLUNGER PISTON	8	HMSE05	15	静摩擦片 STATIC FRICTION	15	
6	滚子 ROLLER	8		16	制动缸 BRAKE CYLINDER	1	
7	活塞环 PISTON RING	8		17	制动轴 BRAKE SHAFT	1	
8	无油轴承 BUSHING	8		18	制动活塞 BRAKE PLUNGER	1	
9	弹簧销 SPRING	8		19	制动缸盖 COVER PLATE	1	



产品详细介绍 (Products are introduced in detail):

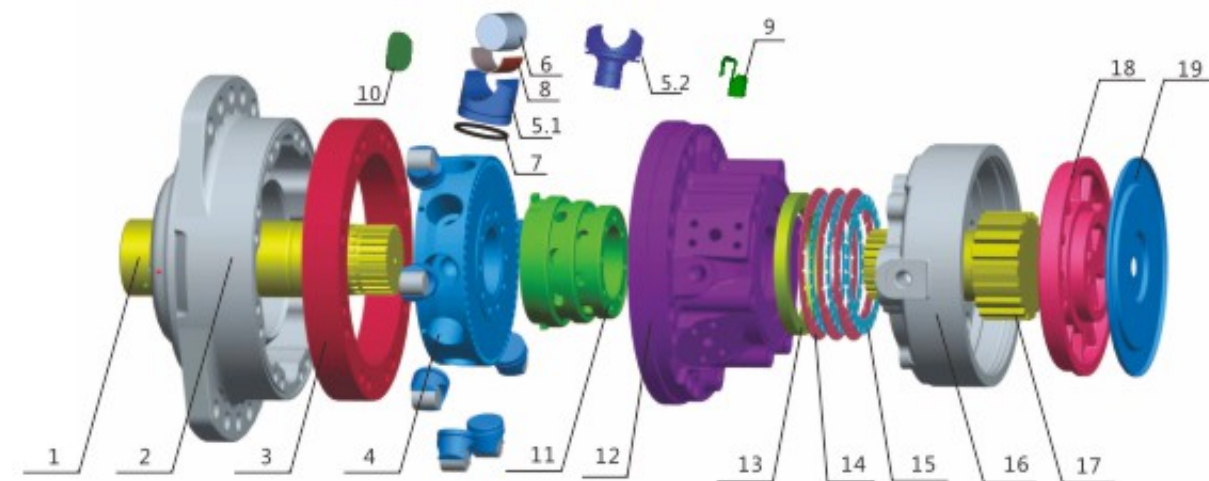

**HMS08/HMSE08**系列零件名称表  
HMS08/HMSE08 series parts list

序号 (ITEM)	部件名称 (DESCRIPTION)	数量 (QUANTITY)	备注 (REMARK)	序号 (ITEM)	部件名称 (DESCRIPTION)	数量 (QUANTITY)	备注 (REMARK)
1	传动轴 DRIVE SHAFT	1		10	柱塞挡板 PLASTIC BLOCK	20	
2	前盖 FRONT COVER	1		11	配流轴 DISTRIBUTOR	1	
3	定子 STATOR	1		12	后盖 REAR COVER	1	
4	转子 ROTOR	1		13	调节垫片 ADJUSTING SHIM	1	
5.1	柱塞 PLUNGER PISTON	10	HMS08	14	动摩擦片 DYNAMIC FRICTION	14	
5.2	柱塞 PLUNGER PISTON	10	HMSE08	15	静摩擦片 STATIC FRICTION	15	
6	滚子 ROLLER	10		16	制动缸 BRAKE CYLINDER	1	
7	活塞环 PISTON RING	10		17	制动轴 BRAKE SHAFT	1	
8	无油轴承 BUSHING	10		18	制动活塞 BRAKE PLUNGER	1	
9	弹簧销 SPRING PIN	10		19	制动缸盖 COVER PLATE	1	



产品详细介绍 (Products are introduced in detail):

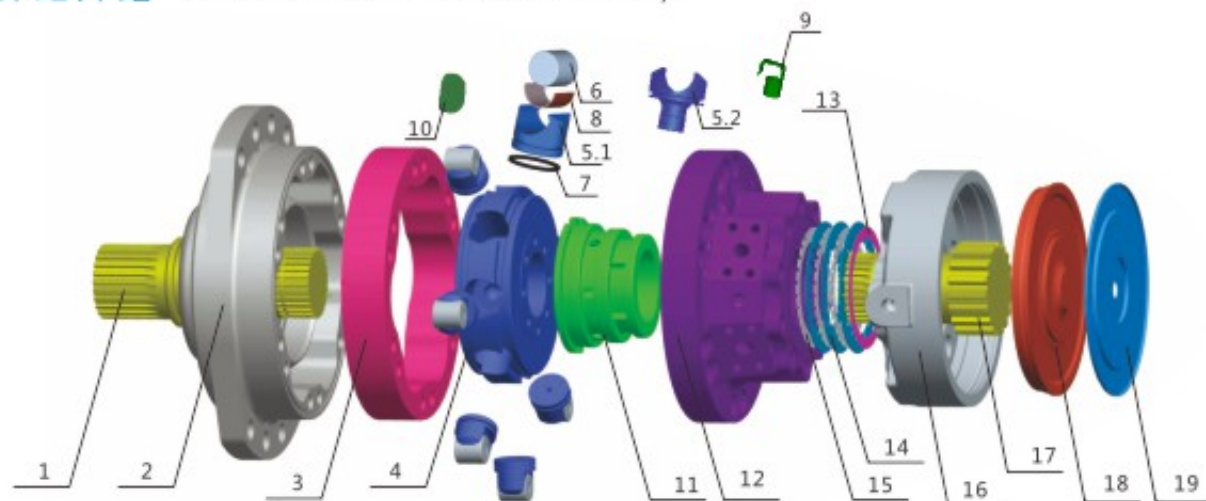

**HMS11/HMSE11** 系列零件名称表  
HMS11/HMSE11 series parts list

序号 (ITEM)	部件名称 (DESCRIPTION)	数量 (QUANTITY)	备注 (REMARK)	序号 (ITEM)	部件名称 (DESCRIPTION)	数量 (QUANTITY)	备注 (REMARK)
1	传动轴 DRIVE SHAFT	1		10	柱塞挡板 PLASTIC BLOCK	16	
2	前盖 FRONT COVER	1		11	配流轴 DISTRIBUTOR	1	
3	定子 STATOR	1		12	后盖 REAR COVER	1	
4	转子 ROTOR	1		13	调节垫片 ADJUSTING SHIM	1	
5.1	柱塞 PLUNGER PISTON	8	HMS11	14	动摩擦片 DYNAMIC FRICTION	19	
5.2	柱塞 PLUNGER PISTON	8	HMSE11	15	静摩擦片 STATIC FRICTION	19	
6	滚子 ROLLER	8		16	制动缸 BRAKE CYLINDER	1	
7	活塞环 PISTON RING	8		17	制动轴 BRAKE SHAFT	1	
8	无油轴承 BUSHING	8		18	制动活塞 BRAKE PLUNGER	1	
9	弹簧销 SPRING PIN	8		19	制动缸盖 COVER PLATE	1	



产品详细介绍 (Products are introduced in detail):

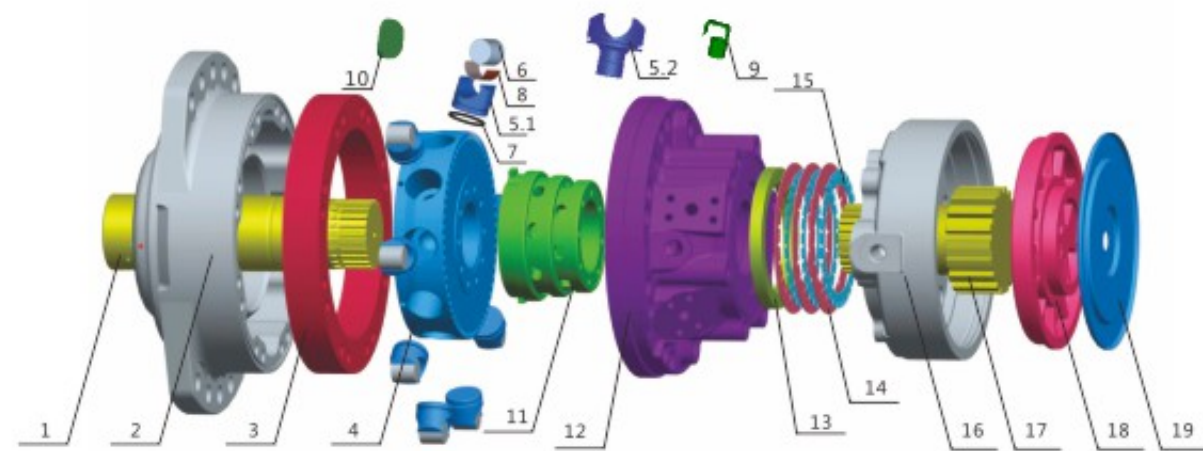

**HMS18/HMSE18** 系列零件名称表  
HMS18/HMSE18 series parts list

序号 (ITEM)	部件名称 (DESCRIPTION)	数量 (QUANTITY)	备注 (REMARK)	序号 (ITEM)	部件名称 (DESCRIPTION)	数量 (QUANTITY)	备注 (REMARK)
1	传动轴 DRIVE SHAFT	1		10	柱塞挡板 PLASTIC BLOCK	20	
2	前盖 FRONT COVER	1		11	配流轴 DISTRIBUTOR	1	
3	定子 STATOR	1		12	后盖 REAR COVER	1	
4	转子 ROTOR	1		13	调节垫片 ADJUSTING SHIM	1	
5.1	柱塞 PLUNGER PISTON	10	HMS18	14	动摩擦片 DYNAMIC FRICTION	19	
5.2	柱塞 PLUNGER PISTON	10	HMSE18	15	静摩擦片 STATIC FRICTION	19	
6	滚子 ROLLER	10		16	制动缸 BRAKE CYLINDER	1	
7	活塞环 PISTON RING	10		17	制动轴 BRAKE SHAFT	1	
8	无油轴承 BUSHING	10		18	制动活塞 BRAKE PLUNGER	1	
9	弹簧销 SPRING PIN	10		19	制动缸盖 COVER PLATE	1	



产品详细介绍 (Products are introduced in detail):

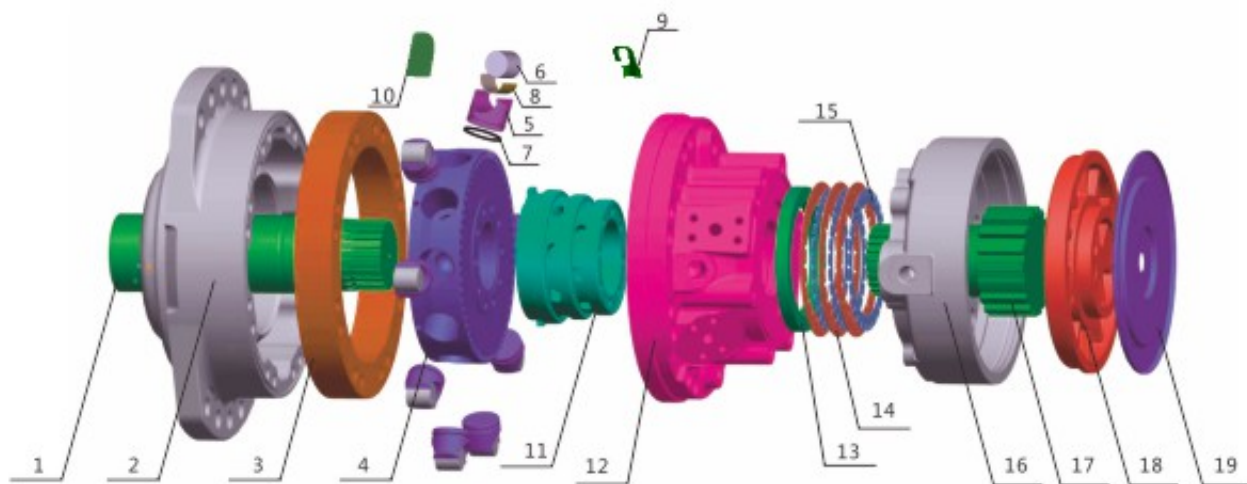

**HMS25** 系列零件名称表  
HMS25 series parts list

序号 (ITEM)	部件名称 (DESCRIPTION)	数量 (QUANTITY)	备注 (REMARK)	序号 (ITEM)	部件名称 (DESCRIPTION)	数量 (QUANTITY)	备注 (REMARK)
1	传动轴 DRIVE SHAFT	1		11	配流轴 DISTRIBUTOR	1	
2	前盖 FRONT COVER	1		12	后盖 REAR COVER	1	
3	定子 STATOR	1		13	调节垫片 ADJUSTING SHIM	1	
4	转子 ROTOR	1		14	动摩擦片 DYNAMIC FRICTION	18	
5	柱塞 PLUNGER PISTON	8		15	静摩擦片 STATIC FRICTION	20	
6	滚子 ROLLER	8		16	制动缸 BRAKE CYLINDER	1	
7	活塞环 PISTON RING	8		17	制动轴 BRAKE SHAFT	1	
8	无油轴承 BUSHING	8		18	制动活塞 BRAKE PLUNGER	1	
9	弹簧销 SPRING PIN	8		19	制动缸盖 COVER PLATE	1	
10	柱塞挡板 PLASTIC BLOCK	16					



产品详细介绍 (Products are introduced in detail):

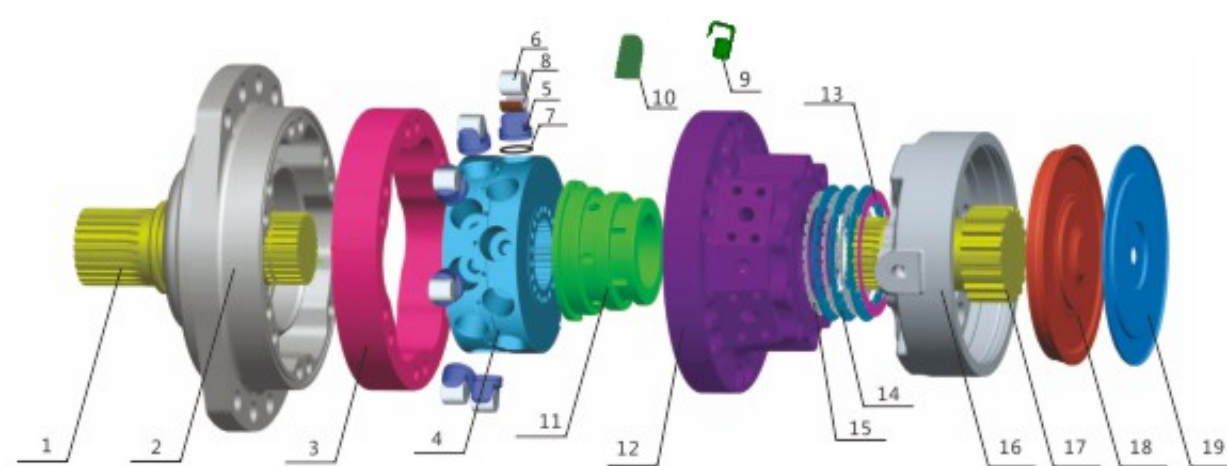

**HMS35** 系列零件名称表  
HMS35 series parts list

序号 (ITEM)	部件名称 (DESCRIPTION)	数量 (QUANTITY)	备注 (REMARK)	序号 (ITEM)	部件名称 (DESCRIPTION)	数量 (QUANTITY)	备注 (REMARK)
1	传动轴 DRIVE SHAFT	1		11	配流轴 DISTRIBUTOR	1	
2	前盖 FRONT COVER	1		12	后盖 REAR COVER	1	
3	定子 STATOR	1		13	调节垫片 ADJUSTING SHIM	1	
4	转子 ROTOR	1		14	动摩擦片 DYNAMIC FRICTION	18	
5	柱塞 PLUNGER PISTON	20		15	静摩擦片 STATIC FRICTION	20	
6	滚子 ROLLER	20		16	制动缸 BRAKE CYLINDER	1	
7	活塞环 PISTON RING	20		17	制动轴 BRAKE SHAFT	1	
8	无油轴承 BUSHING	20		18	制动活塞 BRAKE PLUNGER	1	
9	弹簧销 SPRING PIN	20		19	制动缸盖 COVER PLATE	1	
10	柱塞挡板 PLASTIC BLOCK	40					



产品详细介绍 (Products are introduced in detail):

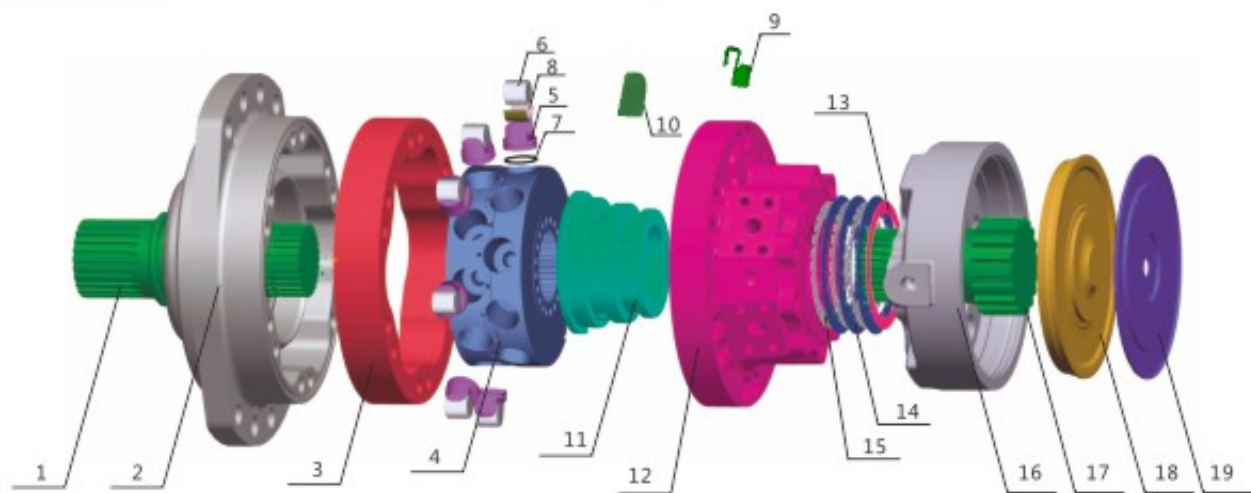

**HMS50** 系列零件名称表  
HMS50 series parts list

序号 (ITEM)	部件名称 (DESCRIPTION)	数量 (QUANTITY)	备注 (REMARK)	序号 (ITEM)	部件名称 (DESCRIPTION)	数量 (QUANTITY)	备注 (REMARK)
1	传动轴 DRIVE SHAFT	1		11	配流轴 DISTRIBUTOR	1	
2	前盖 FRONT COVER	1		12	后盖 REAR COVER	1	
3	定子 STATOR	1		13	调节垫片 ADJUSTING SHIM	1	
4	转子 ROTOR	1		14	动摩擦片 DYNAMIC FRICTION	21	
5	柱塞 PLUNGER PISTON	16		15	静摩擦片 STATIC FRICTION	22	
6	滚子 ROLLER	16		16	制动缸 BRAKE CYLINDER	1	
7	活塞环 PISTON RING	16		17	制动轴 BRAKE SHAFT	1	
8	无油轴承 BUSHING	16		18	制动活塞 BRAKE PLUNGER	1	
9	弹簧销 SPRING PIN	16		19	制动缸盖 COVER PLATE	1	
10	柱塞挡板 PLASTIC BLOCK	32					



产品详细介绍 (Products are introduced in detail):

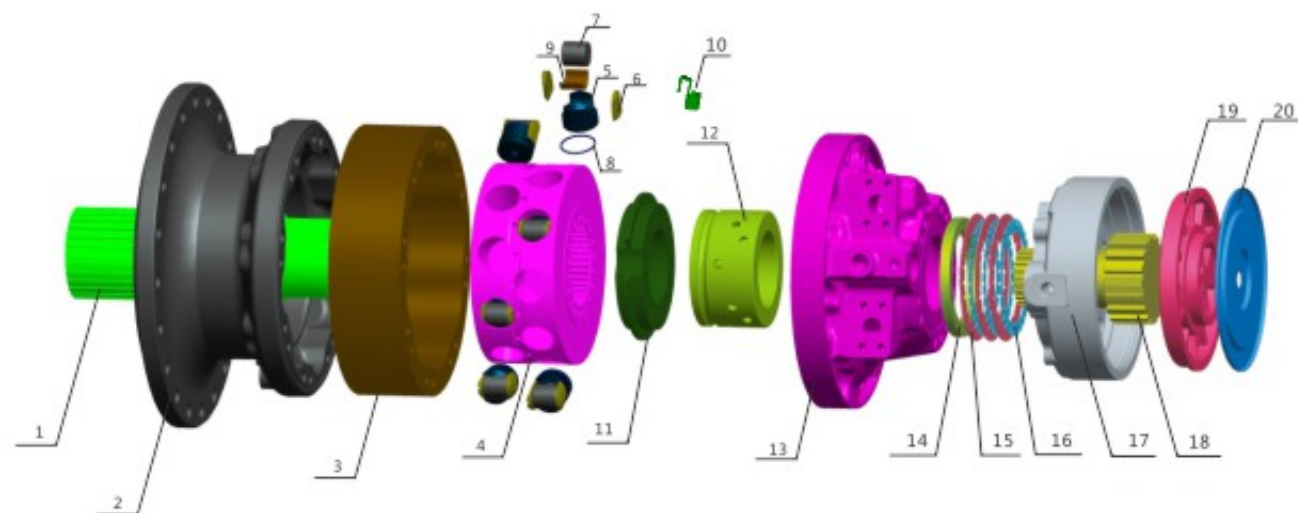

**HMS83** 系列零件名称表  
HMS83 series parts list

序号 (ITEM)	部件名称 (DESCRIPTION)	数量 (QUANTITY)	备注 (REMARK)	序号 (ITEM)	部件名称 (DESCRIPTION)	数量 (QUANTITY)	备注 (REMARK)
1	传动轴 DRIVE SHAFT	1		11	配流盘 VALVE PLATE	1	
2	前盖 FRONT COVER	1		12	配流轴 DISTRIBUTOR	1	
3	定子 STATOR	1		13	后盖 REAR COVER	1	
4	转子 ROTOR	1		14	调节垫片 ADJUSTING SHIM	1	
5	柱塞 PLUNGER PISTON	8		15	动摩擦片 DYNAMIC FRICTION	14	
6	柱塞挡板 PLASTIC BLOCK	16		16	静摩擦片 STATIC FRICTION	15	
7	滚子 ROLLER	8		17	制动缸 BRAKE CYLINDER	1	
8	活塞环 PISTON RING	8		18	制动轴 BRAKE SHAFT	1	
9	无油轴承 BUSHING	8		19	制动活塞 BRAKE PLUNGER	1	
10	弹簧销 SPRING PIN	8		20	制动缸盖 COVER PLATE	1	



产品详细介绍 (Products are introduced in detail):

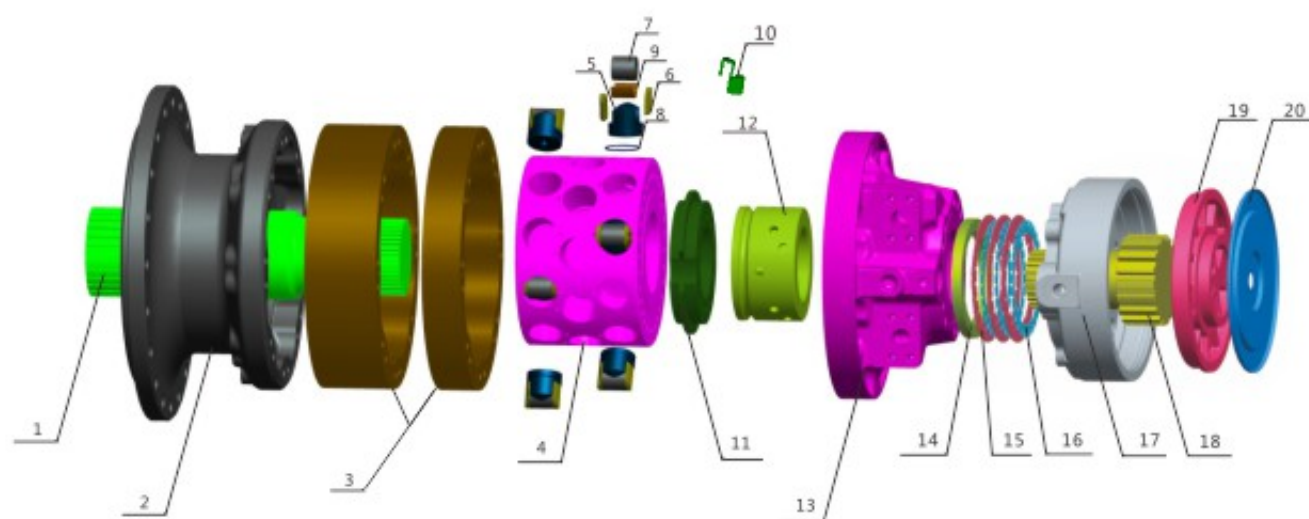

**HMS125**系列零件名称表  
HMS125 series parts list

序号(ITEM)	部件名称(DESCRIPTION)	数量(QUANTITY)	备注(REMARK)	序号(ITEM)	部件名称(DESCRIPTION)	数量(QUANTITY)	备注(REMARK)
1	传动轴 DRIVE SHAFT	1		11	配流盘 VALVE PLATE	1	
2	前盖 FRONT COVER	1		12	配流轴 DISTRIBUTOR	1	
3	定子 STATOR	1		13	后盖 REAR COVER	1	
4	转子 ROTOR	1		14	调节垫片 ADJUSTING SHIM	1	
5	柱塞 PLUNGER PISTON	30		15	动摩擦片 DYNAMIC FRICTION	14	
6	柱塞挡板 PLASTIC BLOCK	60		16	静摩擦片 STATIC FRICTION	15	
7	滚子 ROLLER	30		17	制动缸 BRAKE CYLINDER	1	
8	活塞环 PISTON RING	30		18	制动轴 BRAKE SHAFT	1	
9	无油轴承 BUSHING	30		19	制动活塞 BRAKE PLUNGER	1	
10	弹簧销 SPRING PIN	30		20	制动缸盖 COVER PLATE	1	

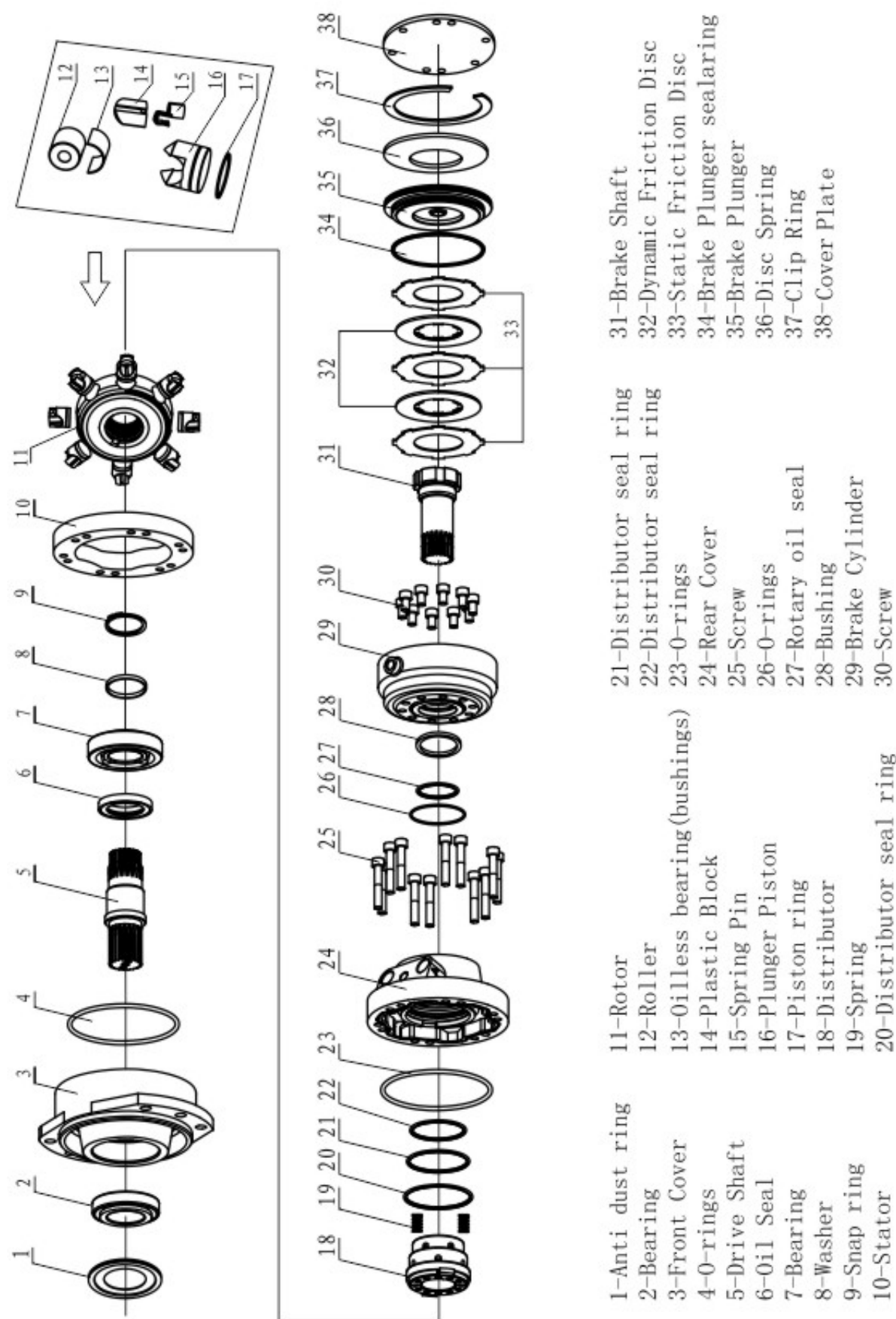

- 1-Anti dust ring
- 2-Bearing
- 3-Front Cover
- 4-0-rings
- 5-Drive Shaft
- 6-Oil Seal
- 7-Bearing
- 8-Washer
- 9-Snap ring
- 10-Stator
- 11-Rotor
- 12-Roller
- 13-Oilless bearing (bushings)
- 14-Plastic Block
- 15-Spring Pin
- 16-Plunger Piston
- 17-Piston ring
- 18-Distributor
- 19-Spring
- 20-Distributor seal ring
- 21-Distributor seal ring
- 22-Distributor seal ring
- 23-0-rings
- 24-Rear Cover
- 25-Screw
- 26-0-rings
- 27-Rotary oil seal
- 28-Bushing
- 29-Brake Cylinder
- 30-Screw
- 31-Brake Shaft
- 32-Dynamic Friction Disc
- 33-Static Friction Disc
- 34-Brake Plunger sealring
- 35-Brake Plunger
- 36-Disc Spring
- 37-Clip Ring
- 38-Cover Plate

铣挖机总成三维爆炸图  
Drum cutter assembly explosive view

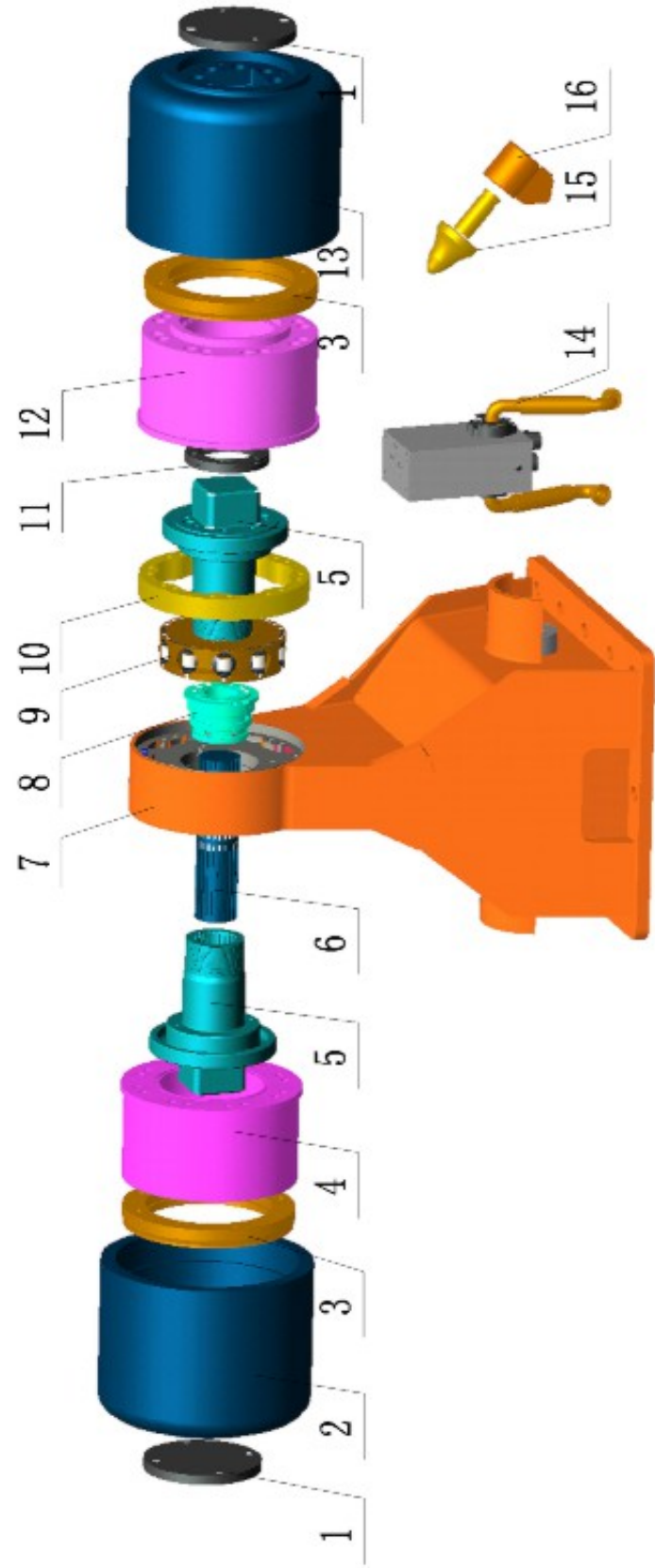

产品详细介绍 ( Products Are Introduced In Detail )

HDC 系列零件名称表 HDC Series Parts List

序号(ITEM)	零件名称(DESCRIPTION)	数量(QUANTITY)	备注(REMARK)	序号(ITEM)	零件名称(DESCRIPTION)	数量(QUANTITY)	备注(REMARK)
1	罩盖 COVER	2		9	转子总成 ROTOR GROUP	1	
2	左罩盖 LEFT HOUSING	1		10	定子 STATOR	1	
3	压板 RETAINER	2		11	锁紧螺母 LOCK NUT	2	
4	左轴承座 L EF DRUM	1		12	右轴承座 RIGH DRUM	1	
5	方轴 SQUARE SHAFT	2		13	右罩盖 RIGH HOUSING	1	
6	联轴器 CONNECTING SHAFT	1		14	控制阀组件 VALVE BLOCK ASSY	1	
7	机架 FRAME	1		15	截齿 PICK(TOOTH)	44/48/56	
8	配流轴 DISTRIBUTOR	1		16	齿座 HOLDER	44/48/56	

发展愿景  
Future vision

从马达、泵、阀等单个产品，到整体的液压系统设计

From produce individual products --motors, pumps, valves... to design and make whole hydraulic system,

